

DuPont Performance Building Solutions



DuPont™ Tyvek® Fluid Applied Flashing Installation Guidelines

Installation Instructions For Windows Installed
AFTER DuPont™ Tyvek® Fluid Applied WB+™

March 2020

Table of Contents

Applicable Products 3

Safety, Handling, and Storage 3

Special Considerations.....4

Installation Instructions.....5

Through Wall Flashing.....12



Applicable Products

DuPont™ Fluid Applied Products

Product	Quantity	Coverage
DuPont™ Tyvek® Fluid Applied WB+™	5 gal, 50 gal	50-65 sf/gal*
DuPont™ Tyvek® Fluid Applied Flashing and Joint Compound+	3.5 gal	50-60 sf/gal*
DuPont™ Tyvek® Fluid Applied Flashing and Joint Compound+ (for gypsum sheathing seam treatment)	28 oz	2.5-3.5 lf/oz
DuPont™ Sealant for Tyvek® Fluid Applied System	28 oz	N/A

*Estimated surface coverage at 25 mils thick.

DuPont Self-Adhered Flashing Products

Product	Width
DuPont™ FlexWrap™ (Formerly FlexWrap™ NF)	6 in 9 in
DuPont™ FlexWrap™ EZ	2.75 in
DuPont™ StraightFlash™	4 in 9 in

Required Materials Based on Project Requirements, Details, and Specifications

Product
DuPont™ Adhesive/Primer

Safety, Handling, and Storage

WARNING: For Professional Use Only. Read and follow the entire Safety, Handling, and Storage section and the Safety Data Sheets (SDSs, formerly MSDSs or Material Safety Data Sheets) carefully before use. The information below is designed to protect the user and allow for safe use and handling of **DuPont™ Tyvek® Fluid Applied Products**. Follow all applicable federal, state, local and employer regulations.

Precautionary Statements

Use only as directed. Avoid inhalation of vapor aerosol. Avoid breathing dust/fumes/gas/mist/vapors/spray. Contaminated work clothing should not be allowed out of the workplace. Wear protective gloves/protective clothing/eye protection/face protection. IF ON SKIN: Wash with plenty of soap and water. IF IN EYES: Rinse cautiously with water for several minutes. Remove contact lenses, if present and easy to do. Continue rinsing. IF exposed or concerned: Get medical advice/attention. Immediately call a POISON CENTER/doctor. If skin irritation or rash occurs: Get medical advice/attention. Wash contaminated clothing before reuse. Store locked up. Dispose of contents/container to an approved waste disposal plant. Vapor and aerosols are harmful if using spray application. Use in a well-ventilated area. Use NIOSH approved respirator. If vapors are inhaled, immediately move from exposure to fresh air and contact a physician. Avoid contact with eyes and skin. See Personal Protective Equipment section below.

Hazard Statements

May cause an allergic skin reaction. May cause serious eye damage. May cause genetic defects. May cause cancer. May damage fertility or the unborn child. May cause irritation. Repeated or prolonged skin contact may cause allergic reactions with susceptible persons. May cause irritation of respiratory tract. This product is a mixture. Health Hazard information is based on its components. **KEEP OUT OF REACH OF CHILDREN**, children can fall in to bucket and drown. Keep children away from bucket with even a small amount of liquid.

Personal Protective Equipment (PPE)

Personal protective equipment (PPE) used during the handling of **Tyvek® Fluid Applied Products** must at a minimum include:

- Protective clothing or coveralls, including long sleeves and head cover (no skin should be exposed), for example, Tyvek® non-woven laminate paint protective coveralls with hood
- Chemical-resistant nitrile, butyl rubber, neoprene or PVC gloves
- Chemical splash impact safety goggles or equivalent, unless using a full-face respirator
- Protective work safety shoes
- Hearing protection such as ear plugs when spraying
- NIOSH-approved particulate filtering full-face respirator with a P95 particulate filter or half-mask respirator with a P95 particulate filter and splash impact goggles when spraying
- NIOSH-approved N95 disposable safety mask with splash impact goggles for manual application such as troweling or rolling, and for clean-up.

Clean Up and Purge

Use appropriate personal protective equipment during clean-up (see Personal Protective Equipment section above). Uncured Tyvek® Fluid Applied products can be cleaned from hands, tools, and equipment by using a citrus based cleaner or mineral spirits. Cured Tyvek® Fluid Applied products can be removed by soaking in citrus based cleaners or using a gel-based paint stripper.

Clean sprayer components and tools with 100% mineral spirits, naphtha, citrus-based cleaners, or gel-based paint stripper. Material should not be left in the pump, hose, gun, or roller. After applying, flush system with a citrus-based cleaner, or 100% mineral spirits until the system is clean. Avoid using water for cleanup. Low pressure portions of the system should be taken apart and cleaned by hand. Before the next usage, flush any remaining solvent out of the system before applying **DuPont™ Tyvek® Fluid Applied WB+™** to the wall substrate. Be sure that system is fully clean of any residual Tyvek® Fluid Applied product before introducing a different product. If

system is not fully clean, ingredients can react and cause products to cure in the system. Spray tips can be cleaned in 100% mineral spirits or naphtha using airbrush cleaning tools.

Shelf Life and Storage

The shelf life is 12 months from the date of manufacture for an unopened container. Reference the "Use By" date printed on the container. Store opened containers with a plastic protective liner to slow cure rate. Before reusing a previously opened container, remove any cured material that may have formed (skinned over) at the top.

DuPont™ Tyvek® Fluid Applied Products should be stored in a clean, dry environment, 50°- 80°F (10° - 27°C). If stored at temperatures below 65°F (18°C), the product must be warmed to a minimum of 65°F (18°C) using standard industry methods prior to spraying for proper atomization at the spray tip. Continuous storage at high temperatures will reduce the shelf life of **Tyvek® Fluid Applied Products**. **Tyvek® Fluid Applied Products** temporarily stored outside should be stored under cover.

Disposal

Dispose of any residual **Tyvek® Fluid Applied Product**, coated debris, or solvent in accordance with applicable federal, state, and local government regulations.

Supplemental Information

Avoid spraying **Tyvek® Fluid Applied WB+™** in very windy conditions. Installing professional should consider if structure should be tented to protect the surrounding area from overspray. Avoid spraying in very dusty conditions.

Special Considerations

Note: **Tyvek® Fluid Applied Products** should only be used for wall systems that include a continuous path for drainage allowing moisture that penetrates the facade to exit to the exterior. The drainage path should be continuous throughout the wall assembly, including but not limited to areas such as eyebrows, band boards, penetrations, or other locations where transitions and changes of plane occur. For membrane drainage wall systems, ensure that the drainage path is not blocked or disrupted to prevent excess moisture buildup in the wall cavity. Proper shingling, sealing, and integration of the **Tyvek® Fluid Applied Products** with kick-out flashings, through wall membranes, window and door flashing, and other wall transitions is essential for moisture drainage to the exterior.

1. Suitable substrates include concrete masonry unit (CMU), concrete (48 hrs. for green concrete), exterior gypsum, OSB, plywood, wood, treated wood and metal.
2. **Tyvek® Fluid Applied Products** should be installed on clean, dry surfaces. Wipe surfaces to remove moisture, dirt, grease and other debris that could interfere with adhesion.
3. **Tyvek® Fluid Applied Products** are designed for above grade application and should not be installed below grade.
4. When **Tyvek® Fluid Applied WB+™** is applied with a sprayer, the outer edges of all interfaces with **DuPont Self-Adhered Flashing Products** should be treated with **DuPont™ Tyvek® Fluid Applied Flashing and Joint Compound+** and tapered to the wall substrate to ensure smooth transitions free of pinholes and voids.
5. **Tyvek® Fluid Applied Products** can be applied to damp surfaces. A surface is considered damp if there is no visible water on the surface and no transfer of water to the skin when touched.
6. When applying **Tyvek® Fluid Applied Products** over wood-based substrates such as OSB, plywood, lumber, and treated lumber, the installing professional should ensure the moisture content, measured with a wood moisture meter in the core of the substrate, is below 20%. Do not cover wood based substrates with Tyvek® Fluid Applied products if moisture content is 20% or above.
7. **Tyvek® Fluid Applied Flashing and Joint Compound+** can be troweled or brushed to the required thickness in any application outlined in the guide.

8. **Tyvek® Fluid Applied Products** should be applied when air and surface temperatures are above 25°F. Do not install once the ambient temperature exceeds 95°F (35°C), unless the application surface is shaded. The maximum surface temperature for application is 140°F (60°C).
9. For best results, the temperature of the **Tyvek® Fluid Applied Products** at the spray tip of standard spray equipment should be 65°F (18°C) or higher. This may require employing measures to keep the pump and spray equipment at temperatures above 65°F (18°C) and/or using an insulated hose. For more information, refer to the *DuPont™ Tyvek® Commercial Solutions Technical Bulletin*, Additional Considerations When Spraying **Tyvek® Fluid Applied WB+™**.
10. The maximum service temperature is 180°F (82°C).
11. **Tyvek® Fluid Applied Products** may be overcoated once a tack-free skin has formed. Exterior insulation and/or exterior facade may be installed after **Tyvek® Fluid Applied Products** have cured for 48 hours. Please refer to Drying/Curing information in the *DuPont™ Tyvek® Fluid Applied WB+™ Wall and Substrate Guidelines*.
12. **Tyvek® Fluid Applied WB+™** may be applied over, and integrated with **Tyvek® Fluid Applied Flashing** once a tack-free skin has formed. Skin time is 1-2 hours at 70°F (20°C) 50% RH.
13. Performance testing, included but not limited to peel adhesion, pull strength analysis, field or third party testing of air and/or water barrier properties, should be conducted after **Tyvek® Fluid Applied Products** are fully cured (~14 days).
14. DuPont requires that **Tyvek® Fluid Applied Products** be covered within 9 months of installation.
15. **DuPont Self-Adhered Flashing Products** are easier to install when air and surface temperatures are above 25°F (-4°C).
16. **DuPont™ Adhesive/Primer**, or recommended primer, is required when applying **DuPont Self-Adhered Flashing Products** on concrete, masonry, and fiber faced exterior gypsum board substrates. The use of **DuPont™ Adhesive/Primer**, or recommended primer, is a recommended best practice for application of **DuPont Self-Adhered Flashing Products** onto wood substrates.
17. Priming is only required for **Tyvek® Fluid Applied Products** when applied to cut edges of exterior gypsum sheathing.
18. Uncured **Tyvek® Fluid Applied Products** must not come in contact with **DuPont™ Tyvek® Mechanically-Fastened Air and Water Barriers** due to potential impact on performance properties.
19. Stirring is not necessary. If separation occurs, gently fold material until mixture is uniform. Avoid any type of mixing that will introduce air into the product.
20. Asphalt based adhesives are not recommended for use with **Tyvek® Fluid Applied Products**.
21. Minor discoloration of the membrane at wood knots, sap, or sheathing inks may occur after curing.
22. When **Tyvek® Fluid Applied Products** are used as the primary air and water barrier, **Tyvek® Mechanically-Fastened Air and Water Barrier Products** may be installed as an "intervening layer" over **Tyvek® Fluid Applied Products** after 24 hours of curing at 70°F (20°C) and 50% RH. For additional information about the use of "intervening layers", see the Stucco section under Facade/Exterior Considerations in the *DuPont™ Tyvek® Fluid Applied WB+™ Wall and Substrate Guidelines*.
23. For **DuPont Self-Adhered Flashing Products**, remove all wrinkles and bubbles that may allow for water intrusion by smoothing surface and repositioning as necessary during installation. Apply pressure along entire surface of flashing for a good bond using firm hand pressure, J-roller, or alternate tool without sharp edges (such as a plastic carpet tuck tool) to assist with application of uniform pressure.

For additional guidance, please call 1-800-448-9835, visit our website at building.dupont.com, or review the DuPont™ Tyvek® Fluid Applied WB+™ System Frequently Asked Questions.

Installation Instructions

The following instructions should be used when the **DuPont Fluid Applied Flashing Products** are installed **AFTER** the **DuPont™ Tyvek® Fluid Applied WB+™**

STEP 1

- A. Install **Tyvek® Fluid Applied WB+™** up to the edge of the rough opening, or to the edge of the wood buck, if applicable. Do not install the **Tyvek® Fluid Applied WB+™** onto the wood buck.

Refer to the current *DuPont™ Tyvek® Fluid Applied WB+™ Wall and Substrate Guidelines* (K-29398) for application instructions. Allow the **Tyvek® Fluid Applied WB+™** to skin over prior to installing the **DuPont™ Tyvek® Fluid Applied Flashing and Joint Compound+.** Exterior insulation and/or cladding may be installed once the membrane has cured sufficiently to resist damage during installation. Skin time is 1-2 hours, and 25 mil is workable in 24 hours at 70°F (20°C), 50% RH.

STEP 2

Clean surfaces of rough opening and area on face of wall around rough opening of any material that could negatively affect adhesion as well as any sharp protrusions.

If applicable, cover holes in studs with patches of **DuPont™ StraightFlash™**.

Apply **DuPont™ Adhesive/Primer** or recommended primer onto the inside of the rough opening at the sill for concrete surfaces.

NOTE: If applying to gypsum sheathing, the cut edge of the gypsum should be primed using **DuPont™ Adhesive/Primer** or recommended primer on all four sides prior to application of **DuPont™ StraightFlash™** and **Tyvek® Fluid Applied Flashing and Joint Compound+.**

Steel Stud with Integral Flanged Window

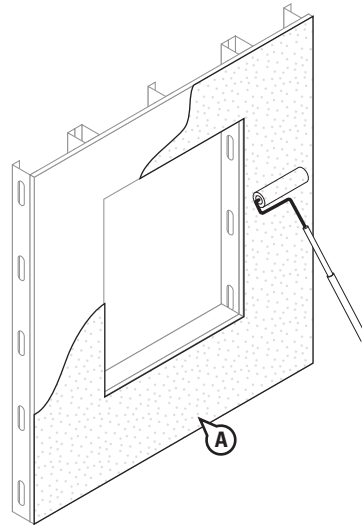

Storefront

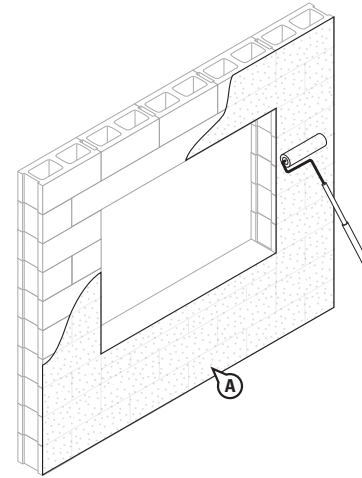

Wood Buck Bump Out with Non-flanged Window

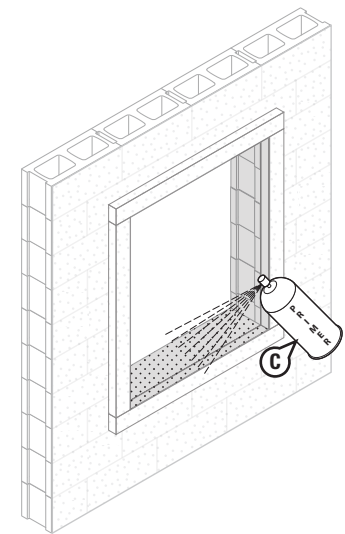
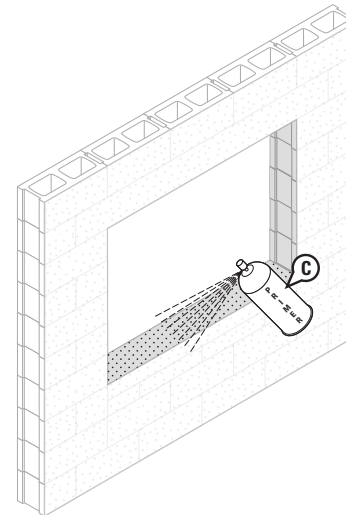
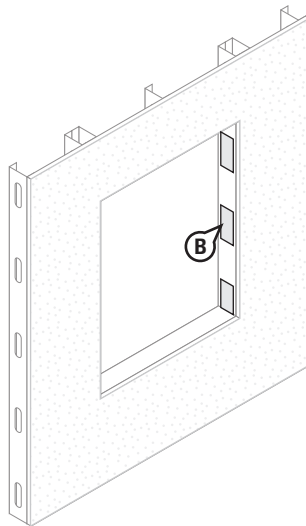
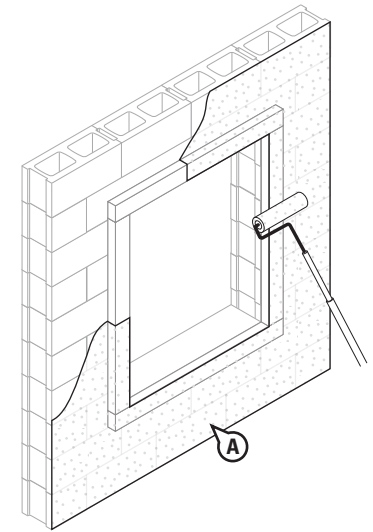

Installation Instructions

STEP 3

DuPont™ StraightFlash™ will be installed onto the sill of the window for added protection when fasteners are required to secure the window at the sill. Skip to Step 4 if fasteners will not be installed at the sill.

- A. Prepare the sill flashing by cutting a piece of **StraightFlash™** the width of the sill (S).
- B. Apply a coat of **DuPont™ Tyvek® Fluid Applied System Product** approximately 3" onto the face of the wall below the sill. The uncured **Tyvek® Fluid Applied System Product** is installed for wet bedding the **StraightFlash™** to ensure good adhesion to the cured **DuPont™ Tyvek® Fluid Applied WB+™**.
- C. Remove the release paper and position **StraightFlash™** onto the sill so 2" extends onto the wet bed of **Tyvek® Fluid Applied System Product** on the face of the wall, or wood buck bump out if applicable, below the sill. Apply pressure along entire surface of **StraightFlash™** for a good bond using firm hand pressure, J-roller, or alternate tool without sharp edges (such as a plastic carpet tuck tool) to assist with application of uniform pressure.

Steel Stud with Integral Flanged Window

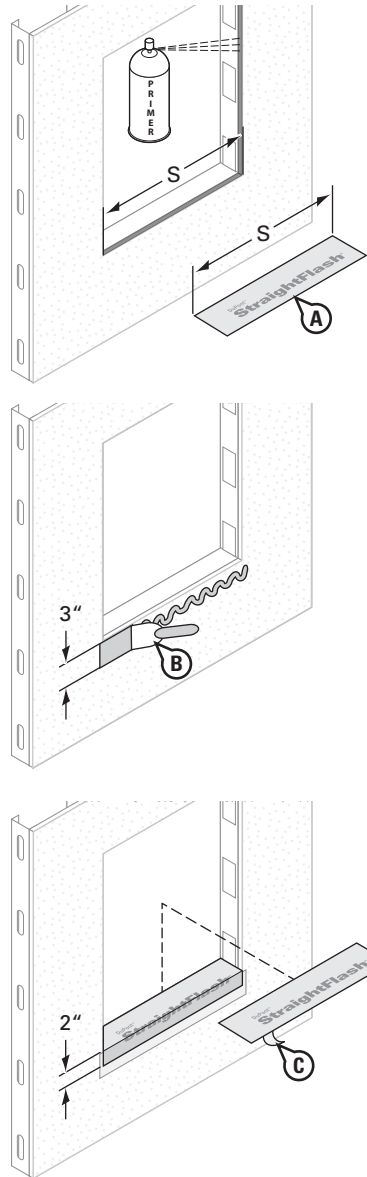

Storefront

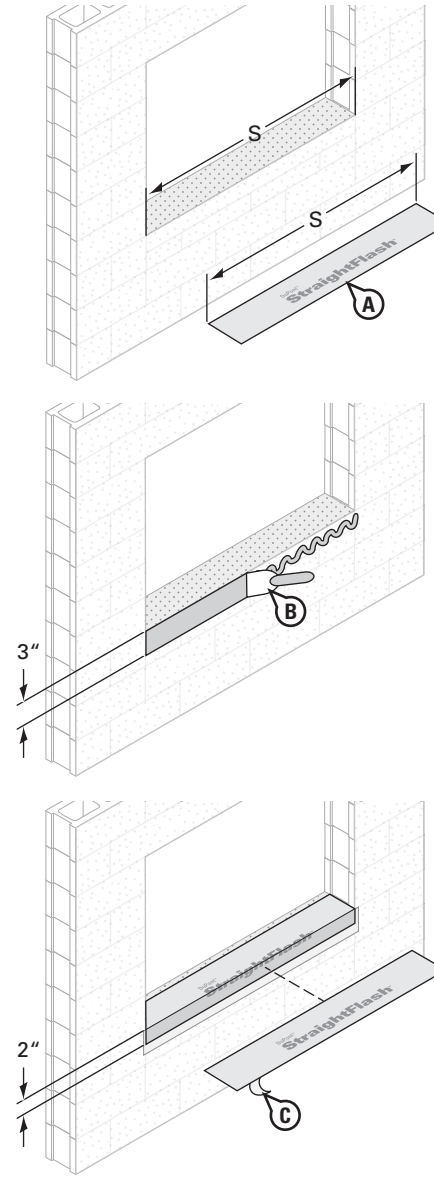

Wood Buck Bump Out with Non-flanged Window

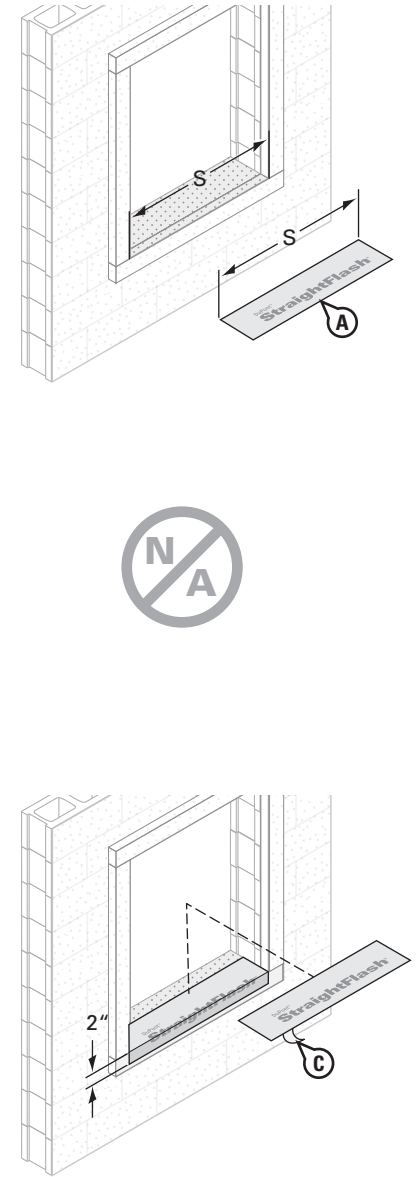

Installation Instructions

STEP 4

- A. Apply a bead of **DuPont™ Tyvek® Fluid Applied Flashing and Joint Compound+** or **DuPont™ Sealant for Tyvek® Fluid Applied System** to all the seams, and fill any holes or cracks in the bump out framing and tool flat.
- B. Apply a fillet bead of **Tyvek® Fluid Applied Flashing and Joint Compound+** or **Sealant for Tyvek® Fluid Applied System** around the perimeter of the wood buck, at the wood buck / wall interface. The fillet bead should extend approximately 1/2" onto both surfaces.
- C. Tool sealant to achieve optimal joint design.

NOTE: DuPont™ Fluid Applied Products may be overcoated once a tack-free skin has formed. Skin time is 1-2 hrs at 70°F (20°C), 50% RH.

Steel Stud with Integral Flanged Window



Storefront



Wood Buck Bump Out with Non-flanged Window

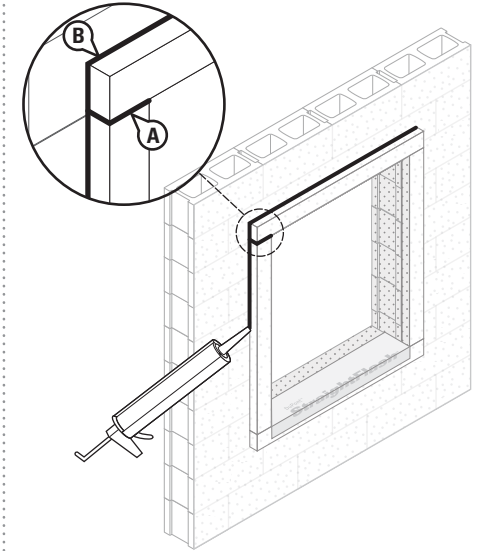

STEP 5

- A. Starting at the window head, apply a bead of **Tyvek® Fluid Applied Flashing and Joint Compound+** onto the inside surface of the rough opening and onto the face of the wall or wood buck.

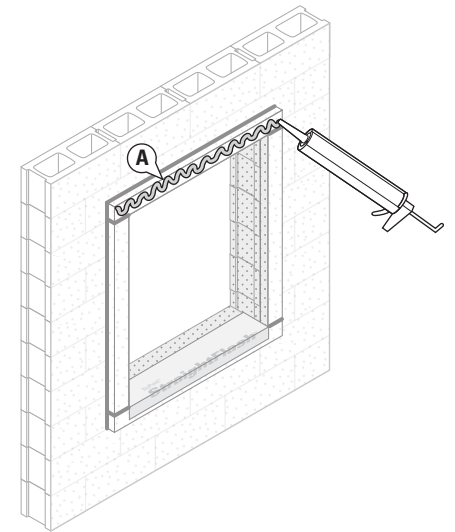
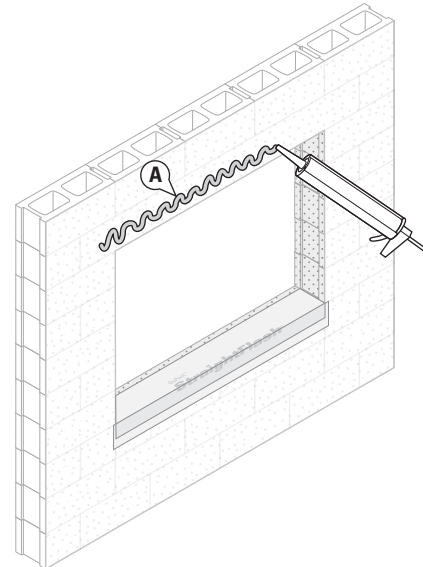
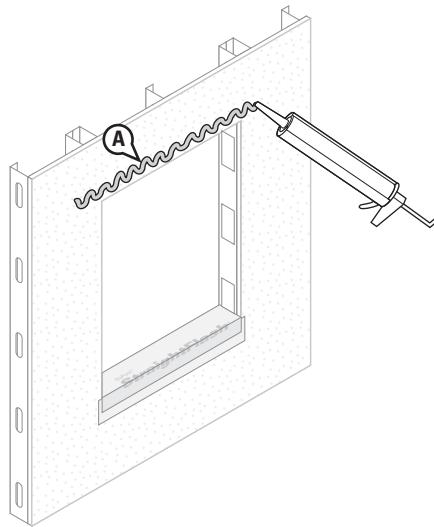

Installation Instructions

- B. Use a trowel or brush to smooth out the **DuPont™ Tyvek® Fluid Applied Flashing and Joint Compound+** to a thickness of approximately 25 mils. The flashing should cover the inside of the rough opening and extend a minimum of 2" onto the face of the wall or wood buck.

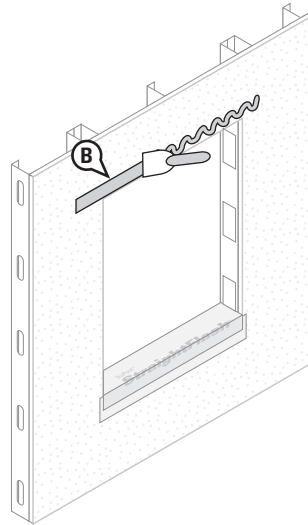

Steel Stud with Integral Flanged Window

Storefront

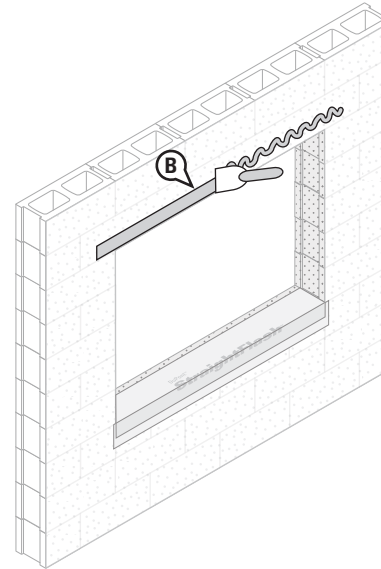

Wood Buck Bump Out with Non-flanged Window

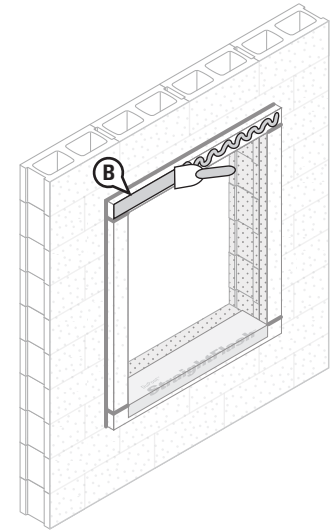

- C. Continue the application process outlined above for the jambs.

NOTE: For the Wood Buck Bump Out with Non-Flanged Window, apply **DuPont™ Tyvek® Fluid Applied Flashing and Joint Compound+** onto all of the outside edges of the wood buck and onto the wall substrate by a minimum of 2".

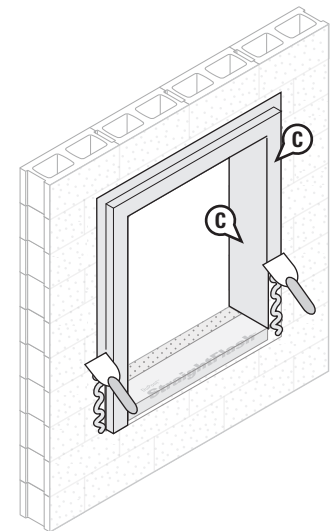
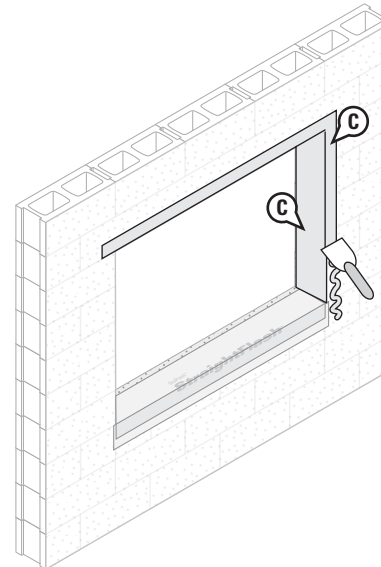
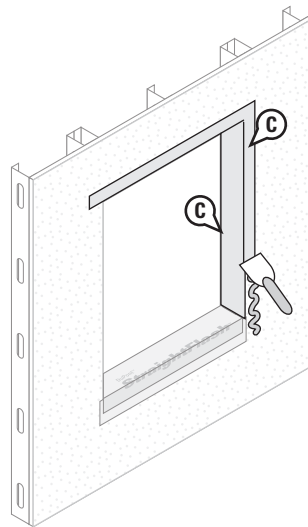

Installation Instructions

- D. The **DuPont™ Tyvek® Fluid Applied Flashing and Joint Compound+** should be applied on the sill and at least 2" on the face of the wall or wood buck substrate. If **DuPont™ StraightFlash™** is installed at sill, the **Tyvek® Fluid Applied Flashing and Joint Compound+** should be installed a minimum of 2" onto the horizontal surface of the **StraightFlash™** at each side of sill. Ensure all inside corners are filled and integrated with the **StraightFlash™**. A corner trowel may be used to smooth outside corners.

Steel Stud with Integral Flanged Window

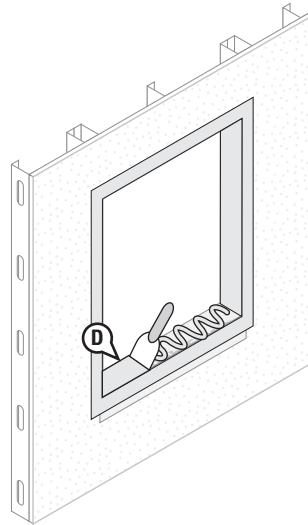

Storefront

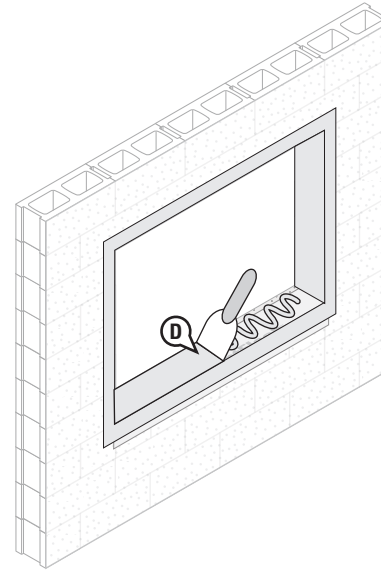

Wood Buck Bump Out with Non-flanged Window

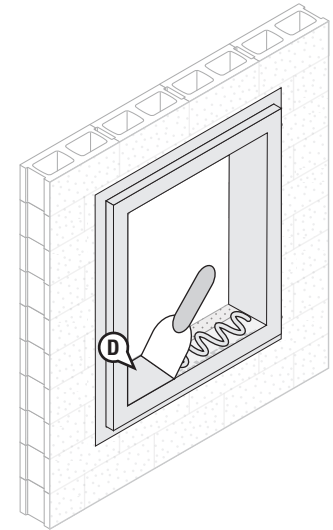

STEP 6

Upon completion, inspect surface, including all corners to ensure that **Tyvek® Fluid Applied Flashing and Joint Compound+** is continuous and **free of any voids or pinholes**.

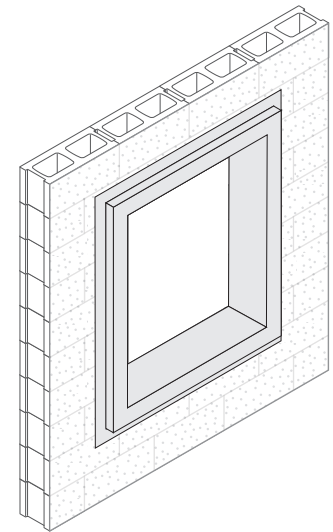
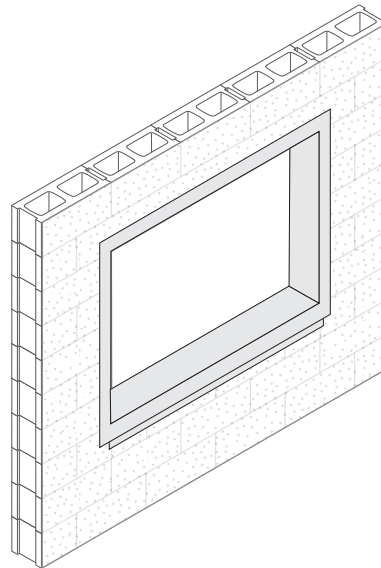
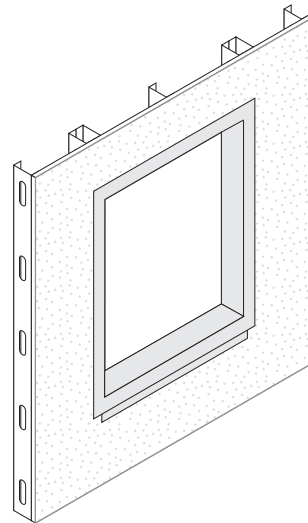

Installation Instructions

STEP 7

After **DuPont™ Tyvek® Fluid Applied Flashing and Joint Compound+** has cured, apply a continuous bead of **DuPont™ Sealant for Tyvek® Fluid Applied System** on the wall around the head and jambs of the window rough opening or onto the back side of the window flanges at the head and jambs. Do not apply sealant across bottom sill flange.

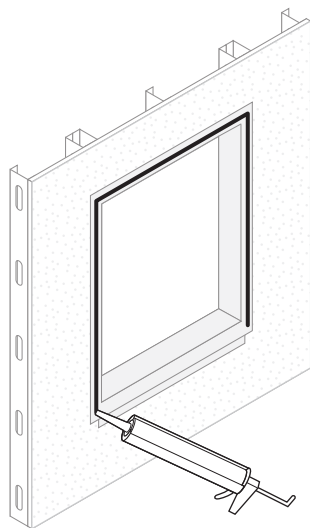

Steel Stud with Integral Flanged Window

STEP 8

Install window per manufacturer's installation instructions.

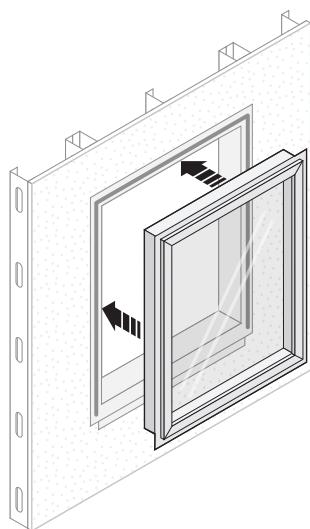

Storefront

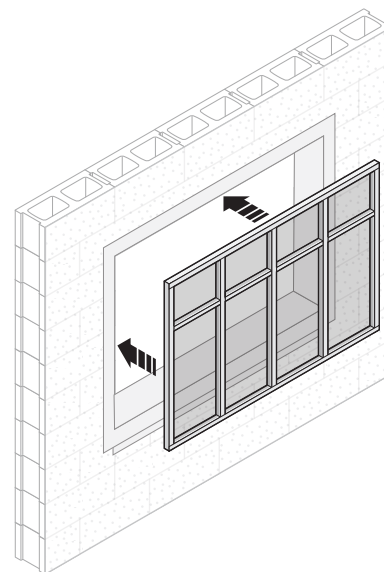

Wood Buck Bump Out with Non-flanged Window

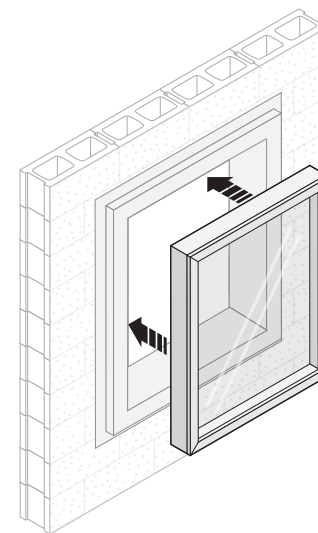

Installation Instructions

STEP 9

- A. Apply a continuous bead of **DuPont™ Tyvek® Fluid Applied Flashing and Joint Compound+** along the interface between the window flange and the wall on the jambs and head of the window.
- B. Use a trowel or brush to smooth **Tyvek® Fluid Applied Flashing and Joint Compound+** to approximately 2" wide x 60 mils thick. The **Tyvek® Fluid Applied Flashing and Joint Compound+** should extend onto the window flange a minimum of a 1/2" past the flange fasteners (approximately 1" onto either side of the flange / wall interface). Upon completion, inspect surface to ensure that **Tyvek® Fluid Applied Flashing and Joint Compound+** application is continuous and **free of any voids or pinholes**.

Steel Stud with Integral Flanged Window

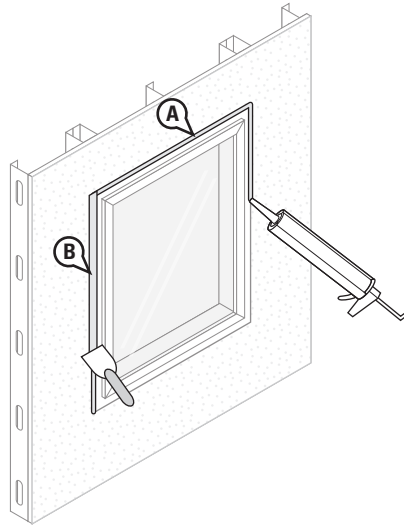

Storefront



Wood Buck Bump Out with Non-flanged Window



STEP 10

Create a continuous perimeter seal between the interior of the window and the flashing using backer rod and **DuPont™ Sealant for Tyvek® Fluid Applied System** along all four sides of the window. When the facade is complete, place a continuous sealant bead integrating the window to the facade.

NOTE: Refer to the Storefront Window CAD details at www.fluidapplied.tyvek.com for more detailed information

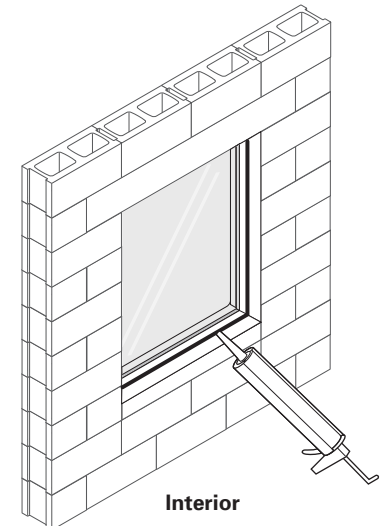
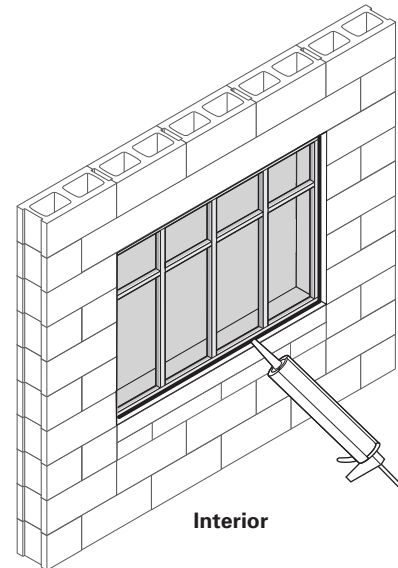
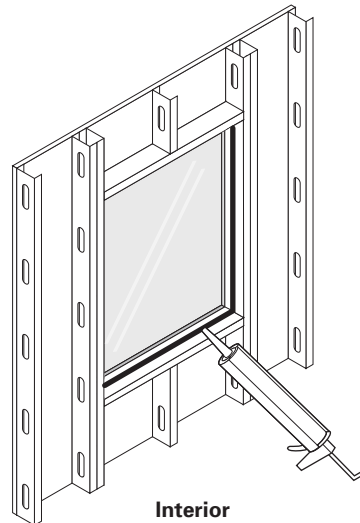

Through Wall Flashing

Lintel at Window Head (After Installation of DuPont™ Tyvek® Fluid Applied System Products)

STEP 1

- A. Install lintel on masonry as required.
- B. Install end dams, beaded in recommended sealant, onto lintel. End dams should extend a minimum of 4" beyond the edge of the window opening.

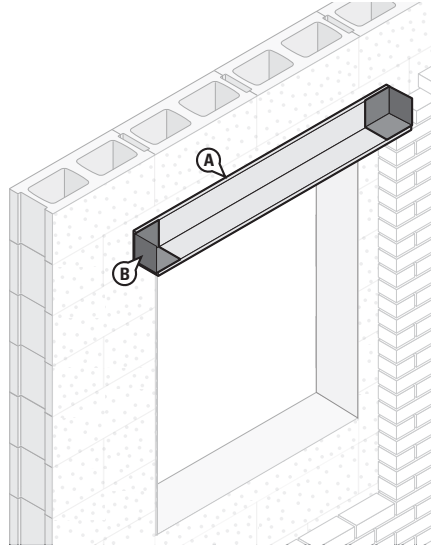

STEP 2

- A. Apply a 25 mil coat of **DuPont™ Tyvek® Fluid Applied System Product** onto the face of the wall, extending approximately 5" above the lintel.
- B. Cut through wall flashing to the length needed to fit between the end dams. Use wide enough through wall flashing to extend 4" up onto the face of the wall.

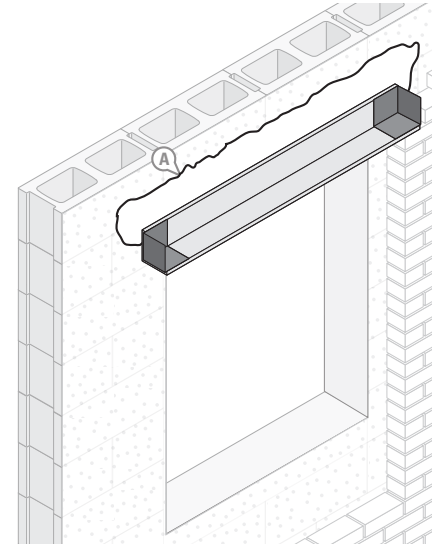

STEP 3

- A. Install through wall flashing on to the wall and lintel with a minimum of 4" adhering to the wall surface.
- B. Terminate the top edge of flashing using mechanical fasteners. As a best practice, DuPont recommends using a termination bar to terminate flashing.

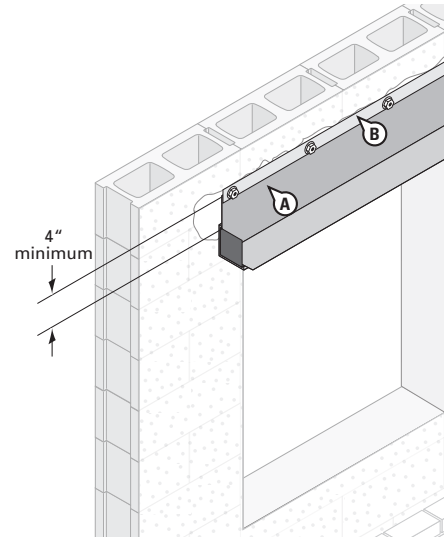

STEP 4

- A. Seal the through wall flashing perimeter, seams, and fasteners using **DuPont™ Sealant for Tyvek® Fluid Applied System** or **DuPont™ Tyvek® Fluid Applied Flashing and Joint Compound+.**
- B. Apply a transition coat of **Tyvek® Fluid Applied Product** across the top edge of the through wall flashing membrane and 1"-2" beyond the bottom of the termination bar.

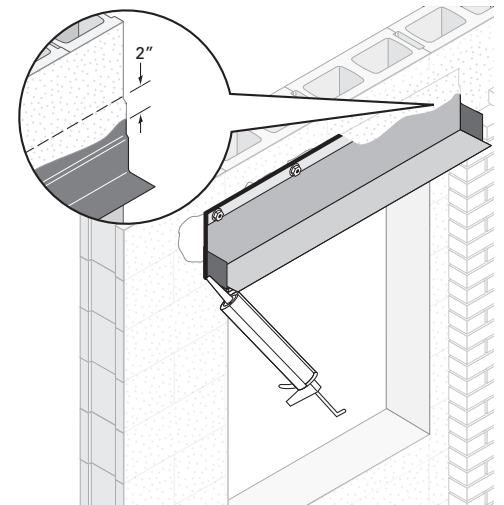

Through Wall Flashing

Shelf Angle

STEP 1

Clean wall and lintel of any material that could negatively affect adhesion as well as any sharp protrusions.

Apply **DuPont™ Adhesive/Primer** or recommended primer approximately 5" onto wall surface above shelf angle.

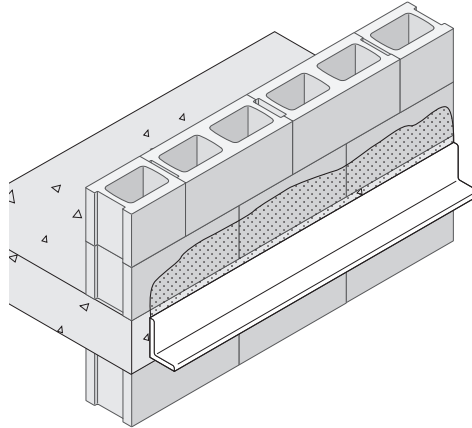

STEP 2

Install self adhered through wall flashing onto the wall and shelf angle with a minimum of 4" adhering to the wall surface.

Terminate the membrane on the vertical wall per plans and specifications. If desired, termination can be performed by using a reglet, counterflashing, termination bar or by embedding in a mortar joint.

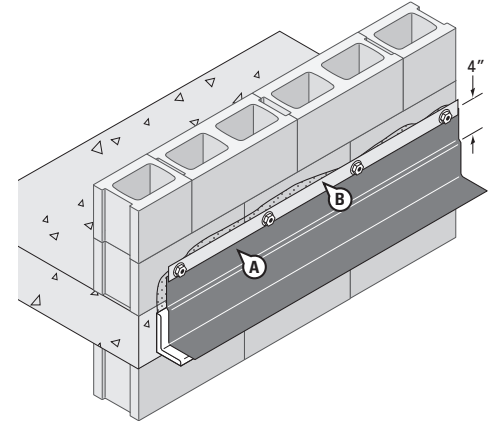

STEP 3

Apply **DuPont™ Sealant for Tyvek® Fluid Applied System** or **DuPont™ Tyvek Fluid Applied Flashing and Joint Compound+** along the perimeter of the through wall flashing and to all seams.

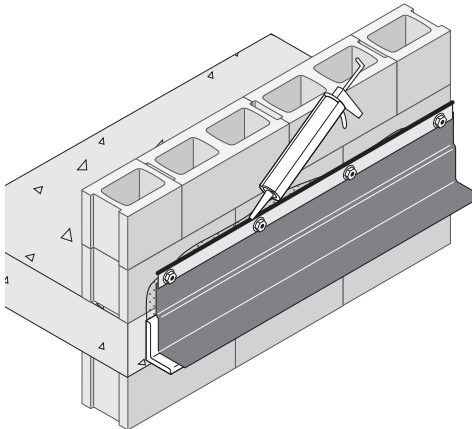

STEP 4

After the **DuPont™ Tyvek® Fluid Applied Product** has formed a tack-free skin, apply **DuPont™ Tyvek® Fluid Applied WB+**™ onto the wall surface, overlapping the through wall flashing by a minimum of 2". Skin time is 1-2 hours at 70°F (20°C), 50% RH. **Tyvek® Fluid Applied WB+**™ should be installed in accordance with the current *DuPont™ Tyvek® Fluid Applied WB Commercial Wall and Substrate Guidelines*. Upon completion, inspect the surface to ensure that the **Tyvek® Fluid Applied WB+**™ is continuous and free of any voids or pinholes.

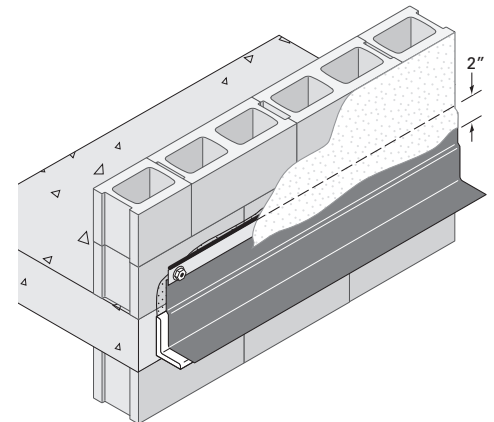

NOTE: If the through wall flashing is to be applied after the **Tyvek® Fluid Applied WB+**™ has been installed, the top of the through wall flashing should be wet bedded into a coat of a **DuPont™ Tyvek® Fluid Applied System Product**. The top should be mechanically fastened, and then the perimeter and all fasteners sealed using a recommended sealant.

Technical Specifications

DuPont™ Tyvek® Fluid Applied Products are formulated to include elastomeric polymers that cure to a continuous, fully-adhered, tough, durable membrane. Additives have been incorporated to provide ultraviolet light resistance. DuPont requires that the **DuPont™ Tyvek® Fluid Applied WB+™** and **DuPont™ Tyvek® Fluid Applied Flashing and Joint Compound+** are to be covered within 9 months of installation

DuPont™ FlexWrap™, **DuPont™ FlexWrap™ EZ**, and **DuPont™ StraightFlash™** are made from 100% butyl adhesive and a top sheet of flash spunbonded high density polyethylene fibers. Additives have been incorporated into these materials to help provide UV light resistance. DuPont requires that **FlexWrap™**, **FlexWrap™ EZ**, and **StraightFlash™** be covered within 9 months of installation.

FlexWrap™, **FlexWrap™ EZ**, and **StraightFlash™** and their release paper are slippery and should not be walked on. Remove release paper from work area immediately. **Tyvek® Fluid Applied Products** are combustible and should be protected from flame and other high heat sources. If burning occurs, ignited droplets may fall away from the point of ignition.

DuPont™ Sealant for Tyvek® Fluid Applied System should be covered within 9 months of installation.

For more information, call 1-800-44-Tyvek

Note

When installed in conjunction with other building materials, **DuPont Self-Adhered Flashing Products** and **Tyvek® Fluid Applied Products** must be properly integrated so that water is diverted to the exterior of the wall system. **Tyvek® Fluid Applied WB+™** is a secondary weather barrier. The outer facade is the primary barrier. Do not install on a wall that does not feature a continuous path for moisture drainage. Any standing water must be allowed to drain off the membrane. You must follow facade manufacturer's installation and maintenance requirements for all facade systems in order to maintain water holdout properties and ensure performance of **Tyvek® Fluid Applied WB+™**. Use of additives, coatings or cleansers on or in the facade system may impact the performance of **Tyvek® Fluid Applied Products**. DuPont products are to be used as outlined in this installation guideline. **DuPont Self-Adhered Flashing Products** and **Tyvek® Fluid Applied Products** should only be used to seal penetrations and flash openings in buildings. Uncured **Tyvek® Fluid Applied Products** must not come in contact with **DuPont™ Tyvek® Mechanically-Fastened Air and Water Barrier Products** due to potential impact on performance properties. **DuPont Self-Adhered Flashing** and **Tyvek® Fluid Applied Products** are not to be used in roofing applications. For superior protection against bulk water penetration, DuPont suggests a system combining a quality exterior facade, a good secondary weather barrier and exterior sheathing, high quality windows and doors, and appropriate flashing materials paying attention to proper installation of each component.

Depending on job site conditions, it is possible that stains may appear, but will not alter performance of the **Tyvek® Fluid Applied Product**.

DuPont believes this information to be reliable and accurate. The information may be subject to revision as additional experience and knowledge is gained. It is the user's responsibility to determine the proper construction materials needed.

For complete warranty information please call 1-800-44-Tyvek or visit building.dupont.com.

This information is not intended to be used by others for advertising, promotion, or other publication for commercial purposes.



© 2020 DuPont. DuPont™, the DuPont Oval Logo, and all trademarks and service marks denoted with ™, SM or ® are owned by affiliates of DuPont de Nemours, Inc. unless otherwise noted.

43-D100709-enNA-0320

For more information about
DuPont Performance Building Solutions,
please call 1-800-448-9835 or visit us at
building.dupont.com