

TYPICAL WALL ASSEMBLY

- VINYL SIDING
- DUPONT™ TYVEK® WRB¹**
- OSB SHEATHING
- WOOD STUDS w/ BATT INSULATION
- VAPOR RETARDER²
- GYPSUM BOARD

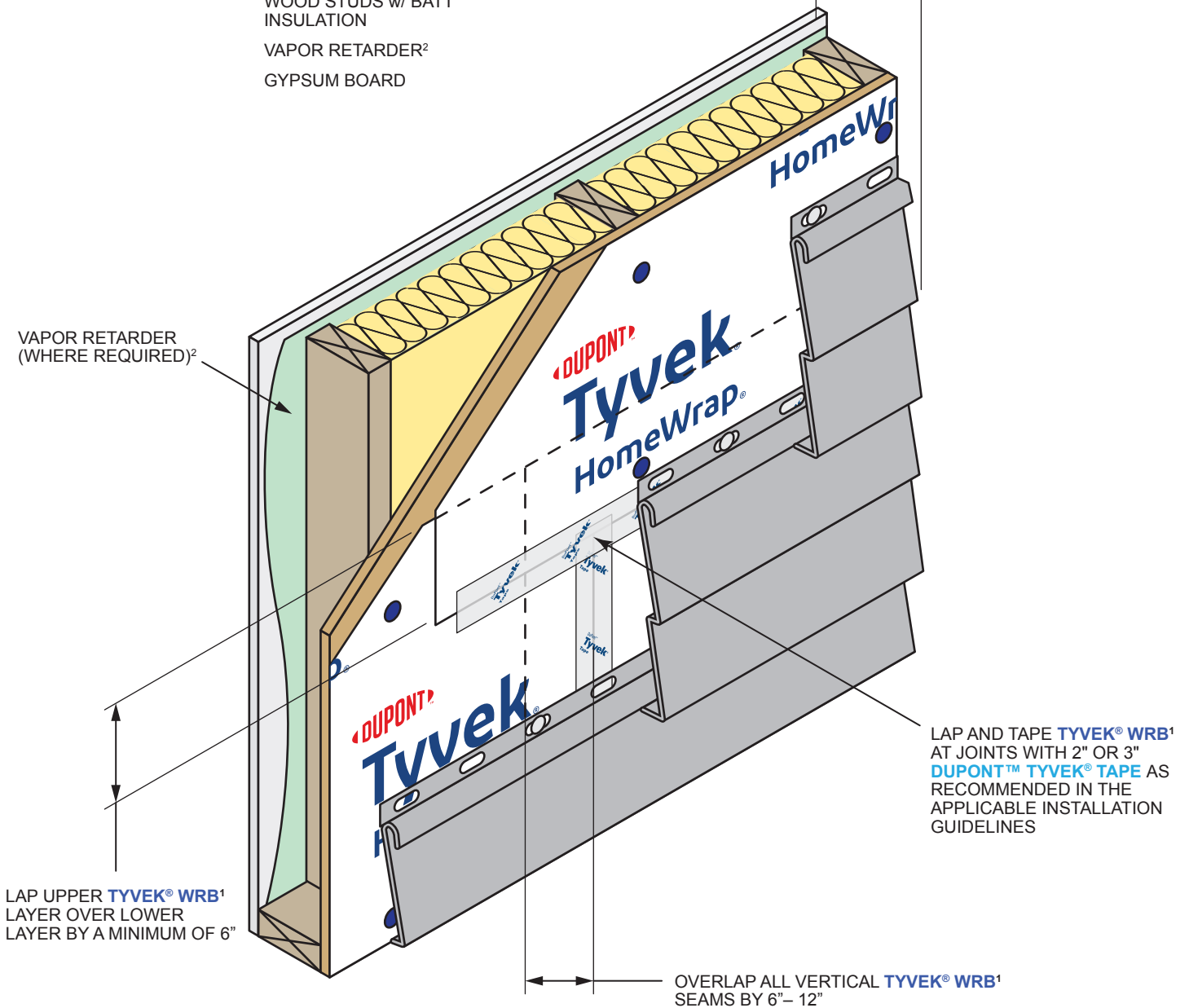

¹REFER TO THE *FACADE CONSIDERATIONS* SECTION OF THE APPLICABLE DUPONT INSTALLATION GUIDELINES TO HELP DETERMINE THE APPROPRIATE **TYVEK® WRB** FOR THE CLADDING TYPE.

²USE OF INTERIOR VAPOR RETARDER IS DEPENDENT UPON CLIMATE ZONE AND LOCAL BUILDING CODES AND LAWS. CONSULT LOCAL JURISDICTION TO ENSURE APPROPRIATE USE OF VAPOR RETARDERS IN WALL ASSEMBLY.

NOTES:

- TAPE ALL **TYVEK® WRB** SEAMS WITH **DUPONT™ TYVEK® TAPE**.
- FLASH ALL PENETRATIONS WITH **DUPONT SELF-ADHERED FLASHING PRODUCTS**.
- FASTEN **TYVEK® WRB** TO SHEATHING WITH APPROVED FASTENERS AND CORRECT SPACING OF WRAP CAP STAPLES/NAILS (ex. **DUPONT™ TYVEK® WRAP CAP FASTENERS**).
- DO NOT APPLY **TYVEK® TAPE** OR **DUPONT SELF-ADHERED FLASHING PRODUCTS** OVER **TYVEK® WRAP CAP FASTENERS**, OR RECOMMENDED FASTENERS; HOWEVER, FASTENERS CAN BE INSTALLED OVER THE FLASHING.
- LOCAL LAWS, ZONING, AND BUILDING CODES VARY AND THEREFORE GOVERNS OVER MATERIAL SELECTION (ex. SHEATHING TYPE, FRAMING SIZE, INSULATION THICKNESS, ETC.) DETAILING SHOWN ABOVE.

SCALE: NOT TO SCALE

REVISION DATE: 4/19/2022

DRAWING: A31

TYPICAL WALL

RESIDENTIAL WOOD FRAME STRUCTURE w/ VINYL SIDING

