

- TYPICAL WALL**
- FINISH COAT
 - BROWN COAT
 - SCRATCH COAT
 - WIRE LATH
 - INTERVENING LAYER
 - TYVEK® WRB¹**
 - SHEATHING
 - WOOD STUDS w/ BATT INSULATION
 - VAPOR RETARDER (WHERE REQUIRED)²
 - GYPSUM BOARD

LAP AND TAPE WITH **DUPONT™ TYVEK® TAPE** AT JOINTS (UPPER SHEET OVER LOWER SHEET)

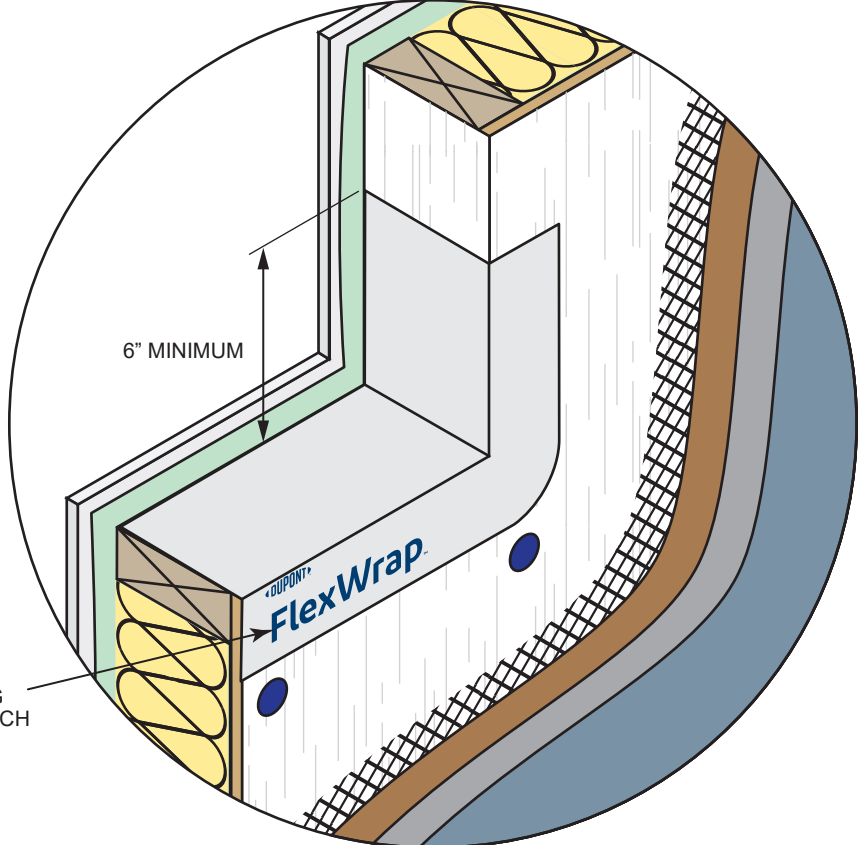

INSTALL **FLEXWRAP™** ALONG ENTIRE SILL AND UP 6" OF EACH JAMB OF ROUGH OPENING

¹REFER TO THE *FACADE CONSIDERATIONS* SECTION OF THE APPLICABLE DUPONT INSTALLATION GUIDELINES TO HELP DETERMINE THE APPROPRIATE **TYVEK® WRB** FOR THE CLADDING TYPE.

²USE OF INTERIOR VAPOR RETARDER IS DEPENDENT UPON CLIMATE ZONE AND LOCAL BUILDING CODES AND LAWS. CONSULT LOCAL JURISDICTION TO ENSURE APPROPRIATE USE OF VAPOR RETARDERS IN WALL ASSEMBLY.

- NOTES:
- TAPE ALL **TYVEK® WRB** SEAMS WITH **DUPONT™ TYVEK® TAPE**.
 - FLASH ALL PENETRATIONS WITH **DUPONT SELF-ADHERED FLASHING PRODUCTS**.
 - FASTEN **TYVEK® WRB** TO SHEATHING WITH APPROVED FASTENERS AND CORRECT SPACING OF WRAP CAP STAPLES/NAILS (ex. **DUPONT™ TYVEK® WRAP CAP FASTENERS**).
 - DO NOT APPLY **TYVEK® TAPE** OR **DUPONT SELF-ADHERED FLASHING PRODUCTS** OVER **TYVEK® WRAP CAP FASTENERS**, OR RECOMMENDED FASTENERS; HOWEVER, FASTENERS CAN BE INSTALLED OVER THE FLASHING.
 - LOCAL LAWS, ZONING, AND BUILDING CODES VARY AND THEREFORE GOVERNS OVER MATERIAL SELECTION (ex. SHEATHING TYPE, FRAMING SIZE, INSULATION THICKNESS, ETC.) DETAILING SHOWN ABOVE.
 - INSTALL STUCCO ACCORDING TO MANUFACTURER'S WRITTEN INSTRUCTIONS.



SCALE: NOT TO SCALE
REVISION DATE: 8/15/2023
DRAWING: A86

WINDOW SILL DETAIL
RESIDENTIAL WOOD FRAME STRUCTURE w/ STUCCO