

## STEP 8

- REMOVE NARROW PIECE OF THE RELEASE PAPER.
- FAN DUPONT™ FLEXWRAP™ AT BOTTOM CORNERS AND ADHERE ONTO EXTERIOR FACE OF WALL. COVERAGE SHOULD BE 2" TO 3" INCHES ONTO THE FACE OF THE WALL.
- PRESS SILL FLASHING W/ FIRM HAND PRESSURE OR J-ROLLER TO ENSURE FULL ADHESION ON ALL SURFACES.

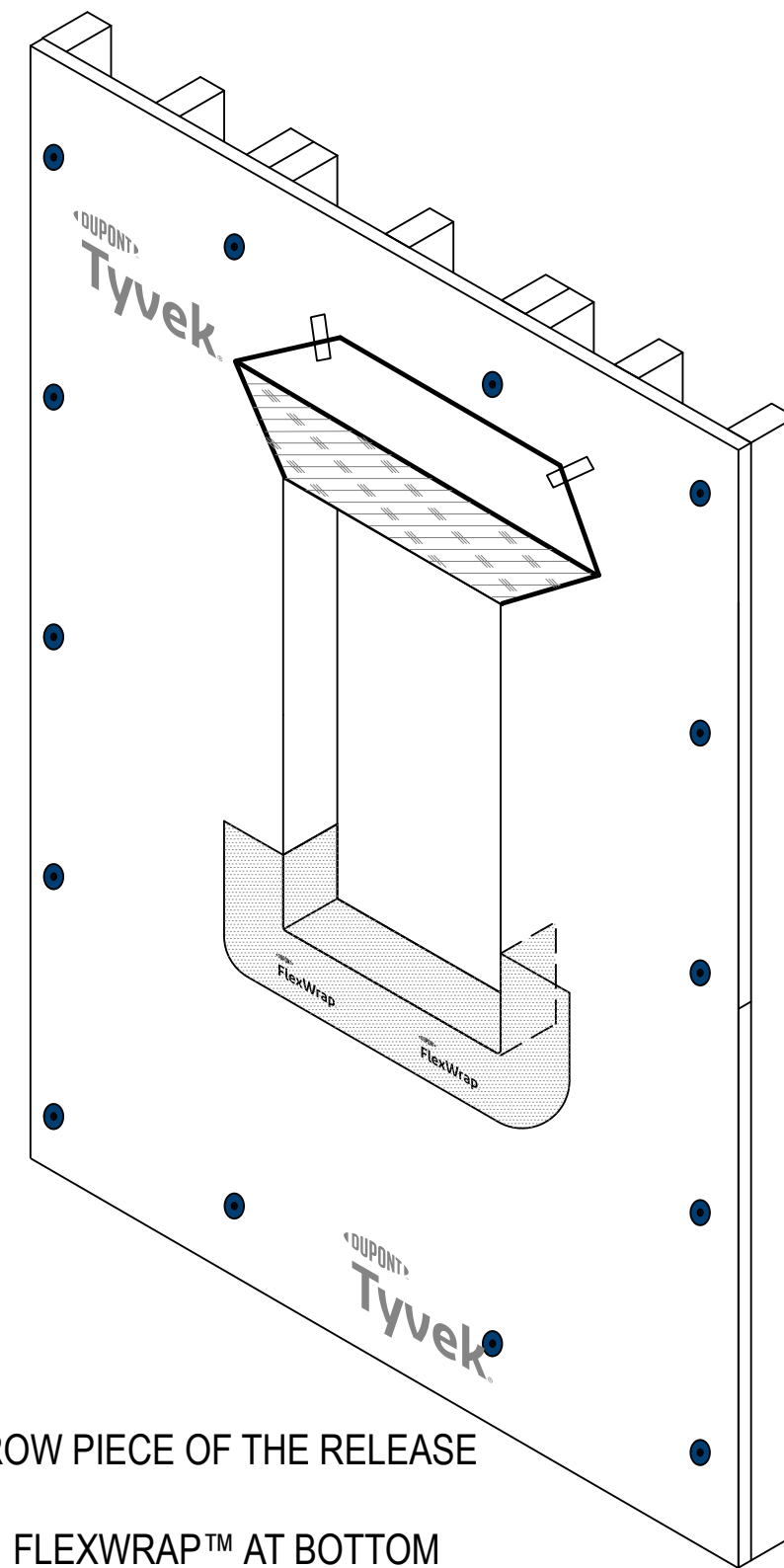

## STEP 7

- REMOVE WIDE PIECE OF RELEASE PAPER. POSITION ON HORIZONTAL SILL BY ALIGNING THE INSIDE EDGE OF THE NARROW RELEASE PAPER WITH THE FACE OF THE WALL TO ENSURE 2" 3" OF THE FLEXWRAP™ WILL BE ADHERED TO THE FACE OF THE WALL WITH A MINIMUM OF 6" UP EACH JAMB.
- ADHERE INTO ROUGH OPENING. **DO NOT STRETCH** MATERIAL ALONG THE SILL OR JAMB.

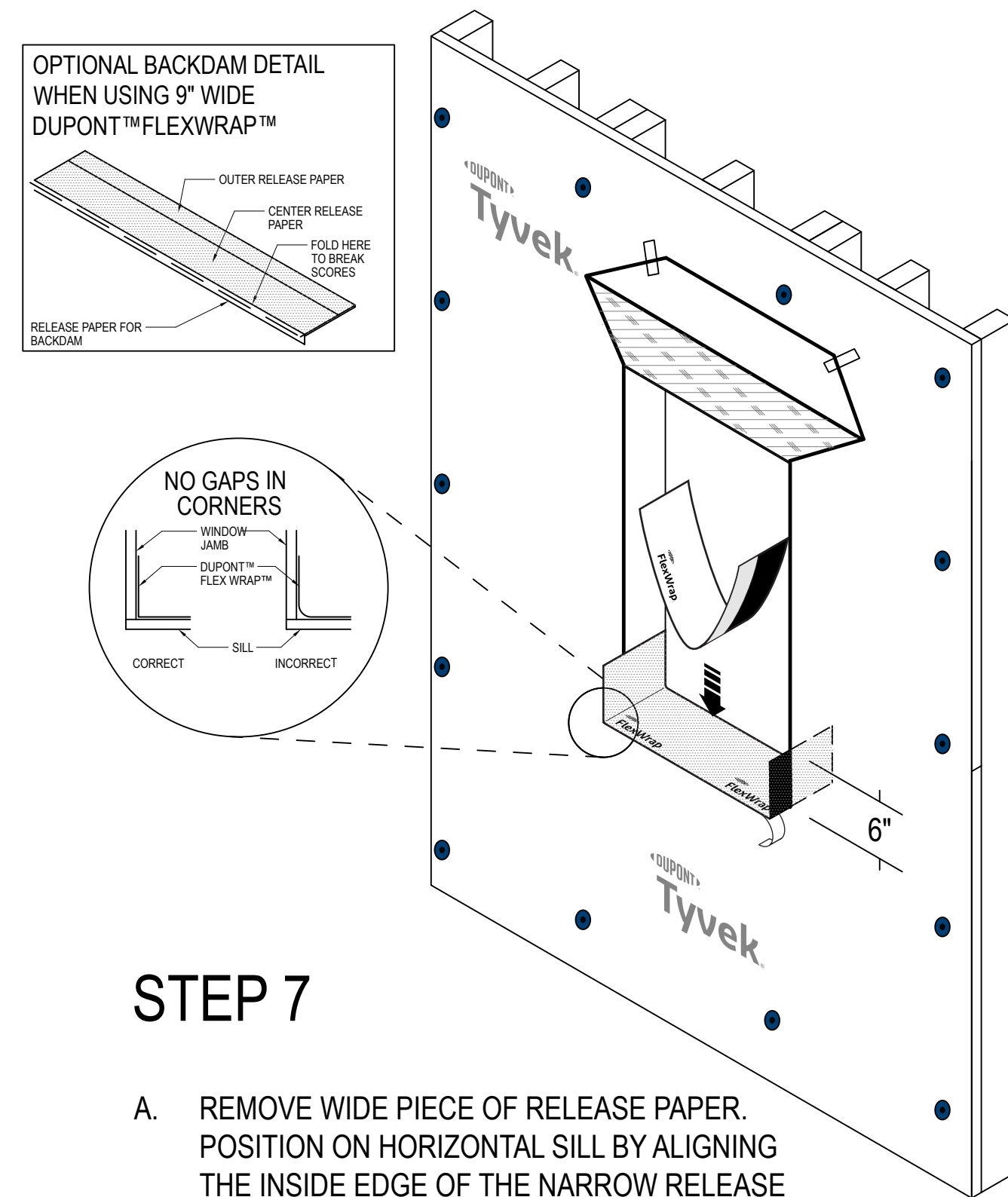

## STEP 6

- PREPARE THE SILL FLASHING BY CUTTING A PIECE OF FLEXWRAP™ THAT IS AT LEAST 12" LONGER THAN THE WIDTH OF THE ROUGH OPENING SILL (S).
- USE 6" FLEXWRAP™ FOR 2"x 4" FRAMING AND 9" FLEXWRAP™ FOR 2"x 6" FRAMING.
- INSPECT INSTALLATION SURFACE TO ENSURE THE SURFACE IS FREE OF DIRT AND SUBSTANCES THAT COULD INTERFERE WITH ADHESION AS WELL AS ANY SHARP PROTRUSIONS.

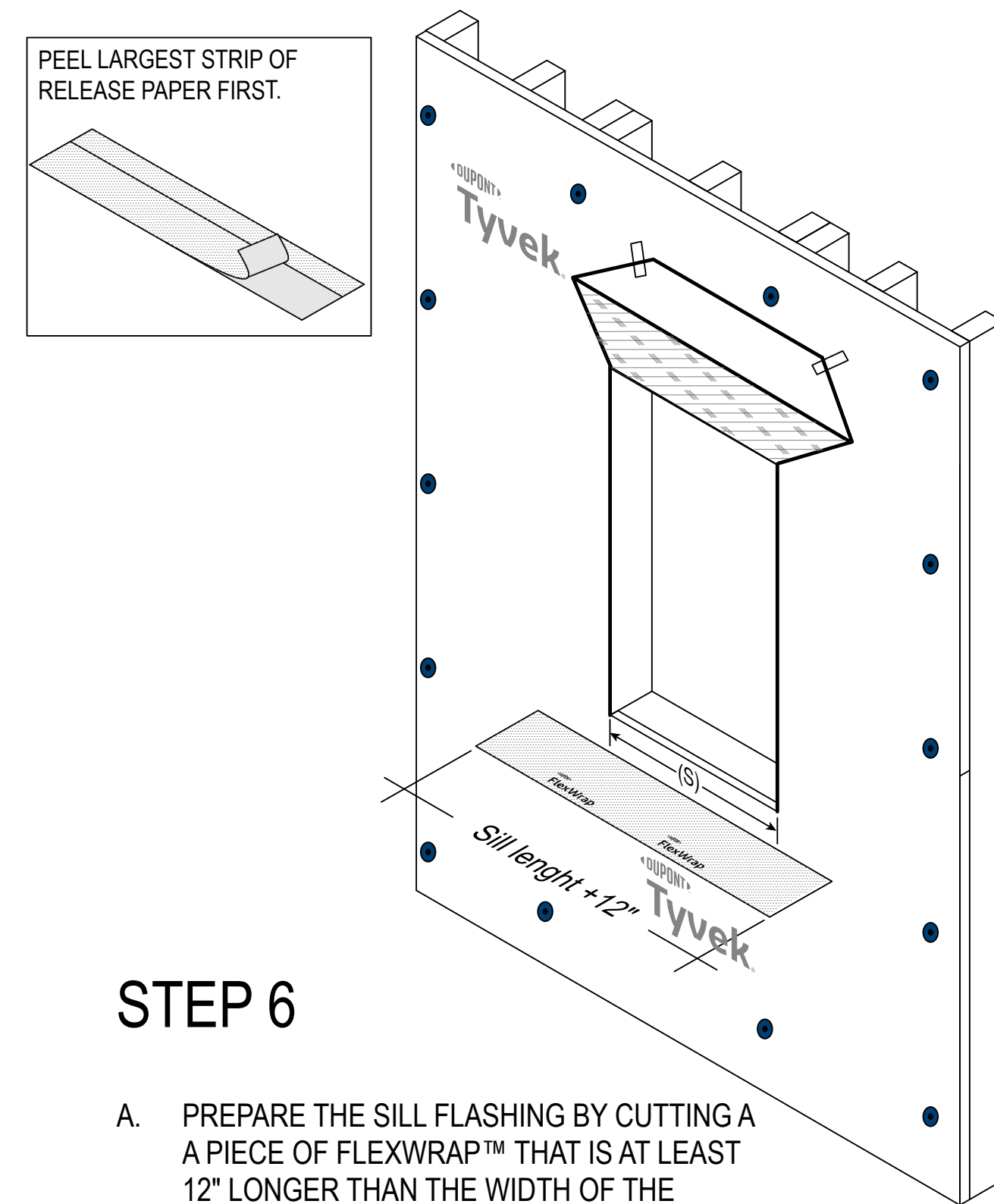

## STEP 5

- FLIP HEAD FLAP UP TO EXPOSE THE SHEATHING AND TEMPORARILY SECURE WITH DUPONT™ TYVEK® TAPE.

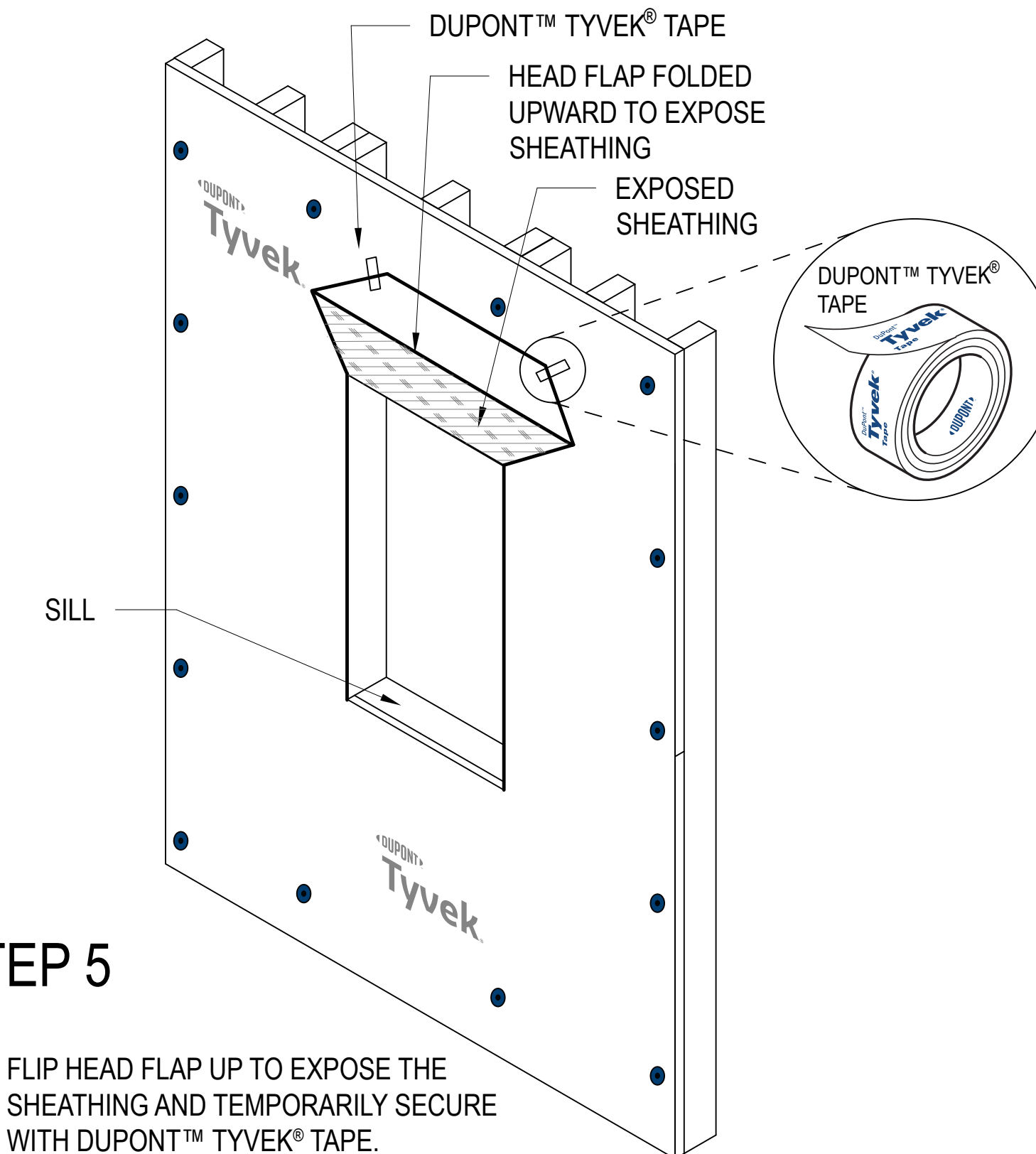

## STEP 4

- FOLD SIDE FLAPS INTO ROUGH OPENING. SECURE TO INSIDE WALL, AND CUT OFF EXCESS FLAPS IF DESIRED.

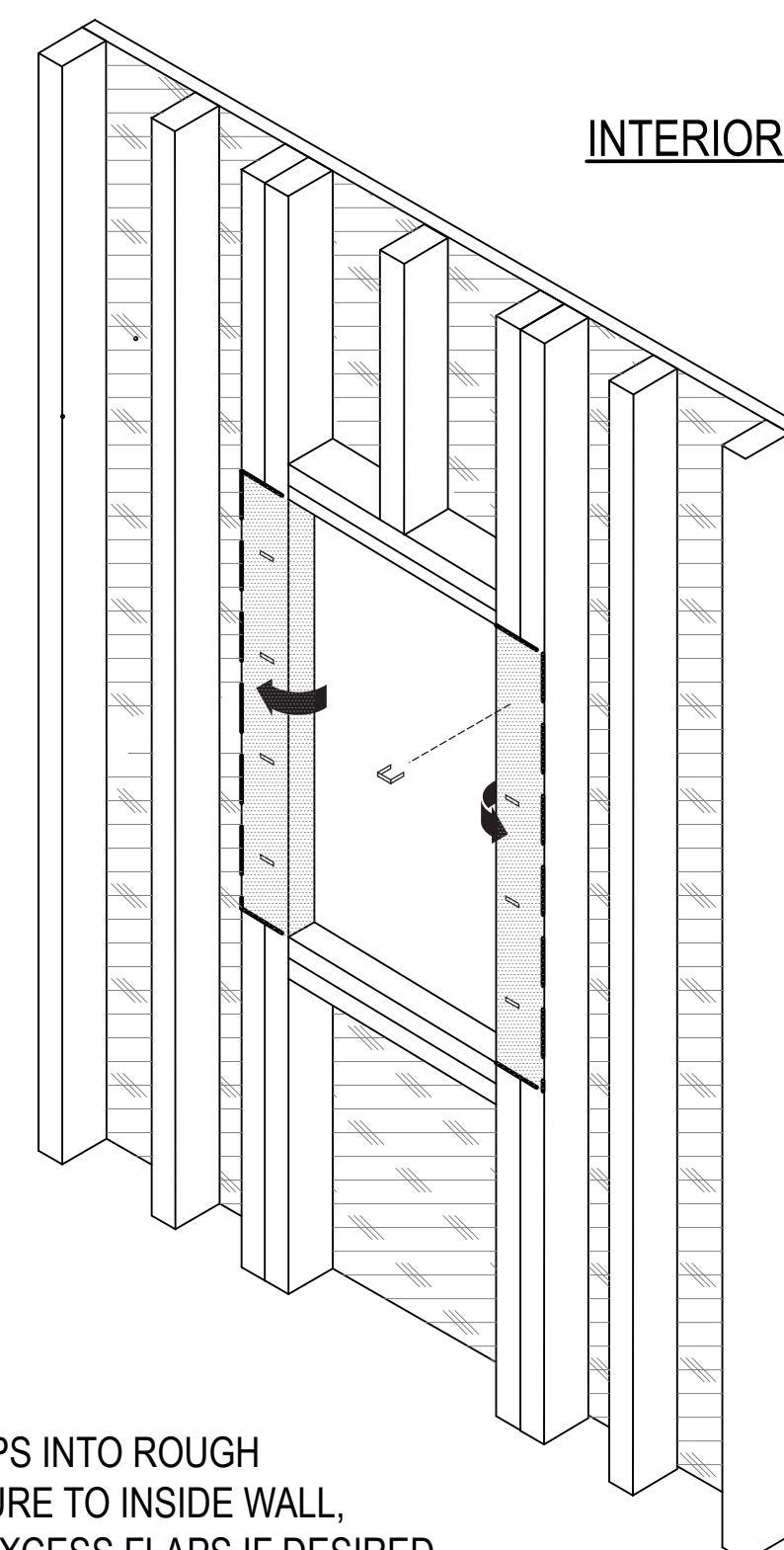

## STEP 3

- CUT AN "I-CUT" IN THE TYVEK® WRB.
- CUT TWO 45 DEGREE SLITS EXTENDING A MINIMUM OF 8" FROM THE CORNERS OF THE HEAD OPENINGS TO EXPOSE SHEATHING OR FRAMING MEMBERS TO ALLOW HEAD FLASHING INSTALLATION.

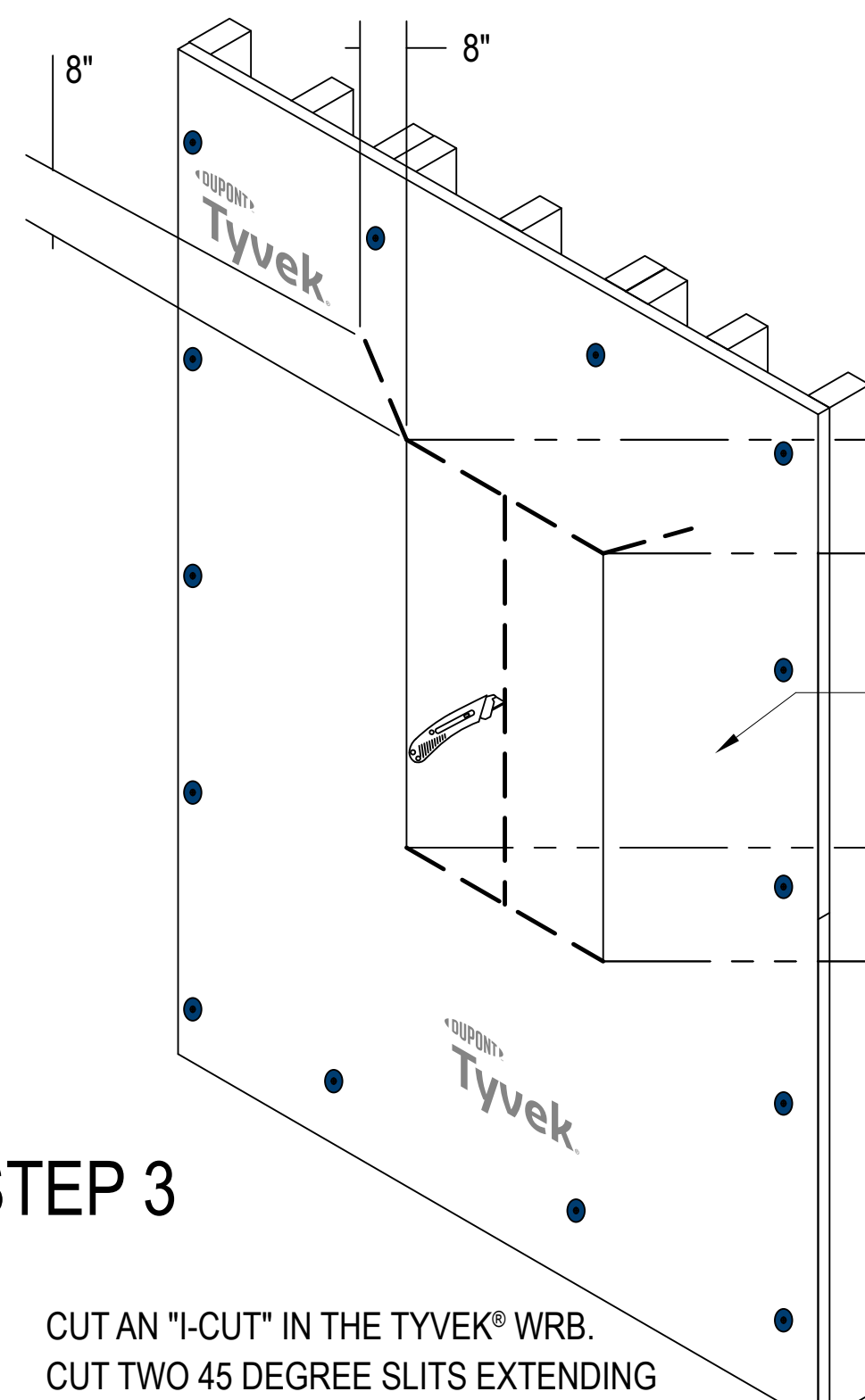

## STEP 2

- DUPONT™ TYVEK® WRB TO BE MECHANICALLY FASTENED AND INSTALLED OVER SHEATHING.
- DO NOT INSTALL** FASTENERS WITHIN 6" OF THE SILLS AND JAMBS OF THE OPENINGS AND WITHIN 9" OF THE HEAD OPENINGS.

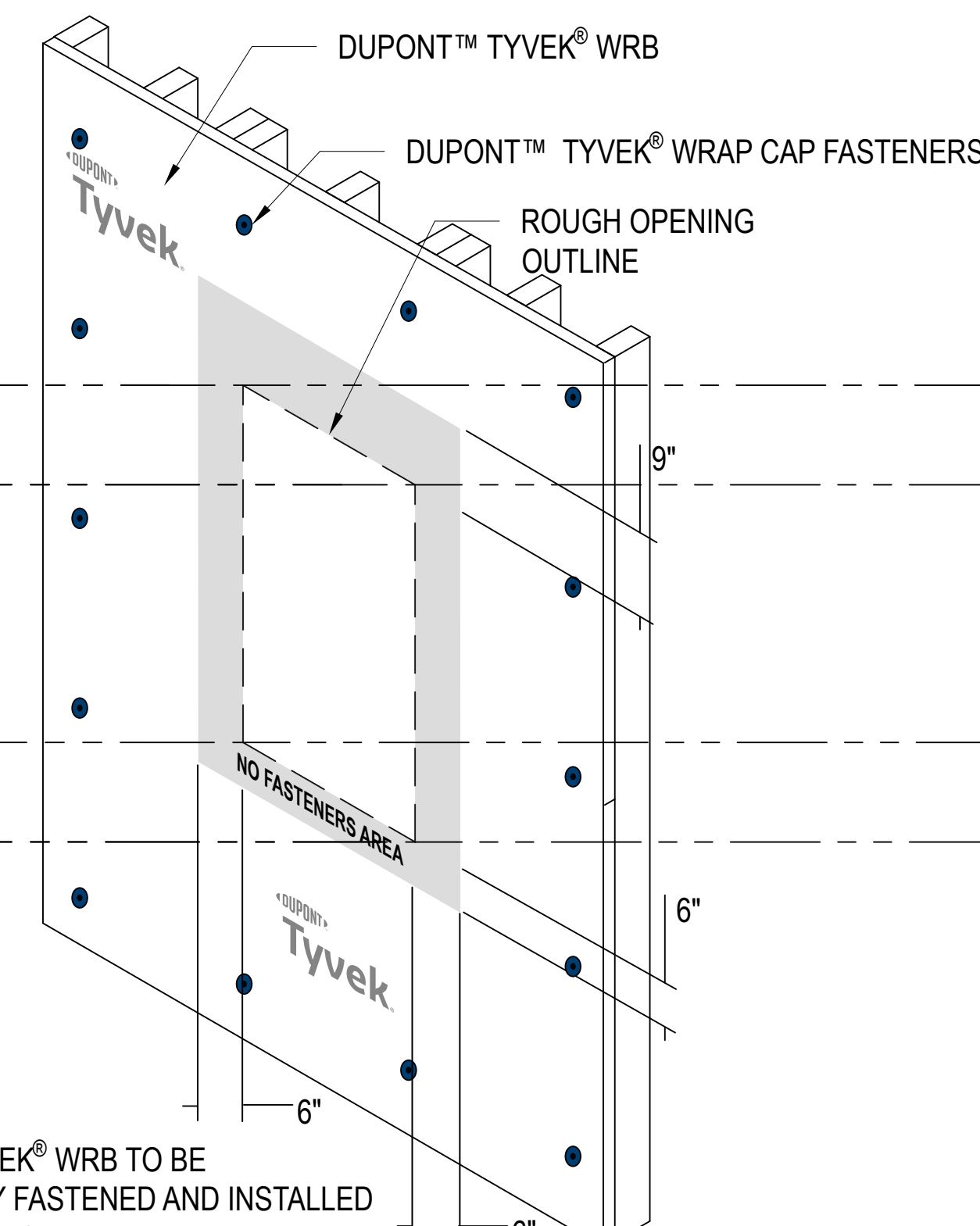

## STEP 1

- SHEATHING INSTALLED OVER BARE STUDS.
- AFTER SHEATHING HAS BEEN INSTALLED, CUT AN OPENING IN THE SHEATHING ALONG THE PERIMETER OF THE ROUGH OPENING FOR WINDOW.
- ENSURE THE SHEATHING IS CUT FLUSH WITH OR SLIGHTLY BELOW THE SILL FRAMING TO ALLOW FOR POSITIVE DRAINAGE.

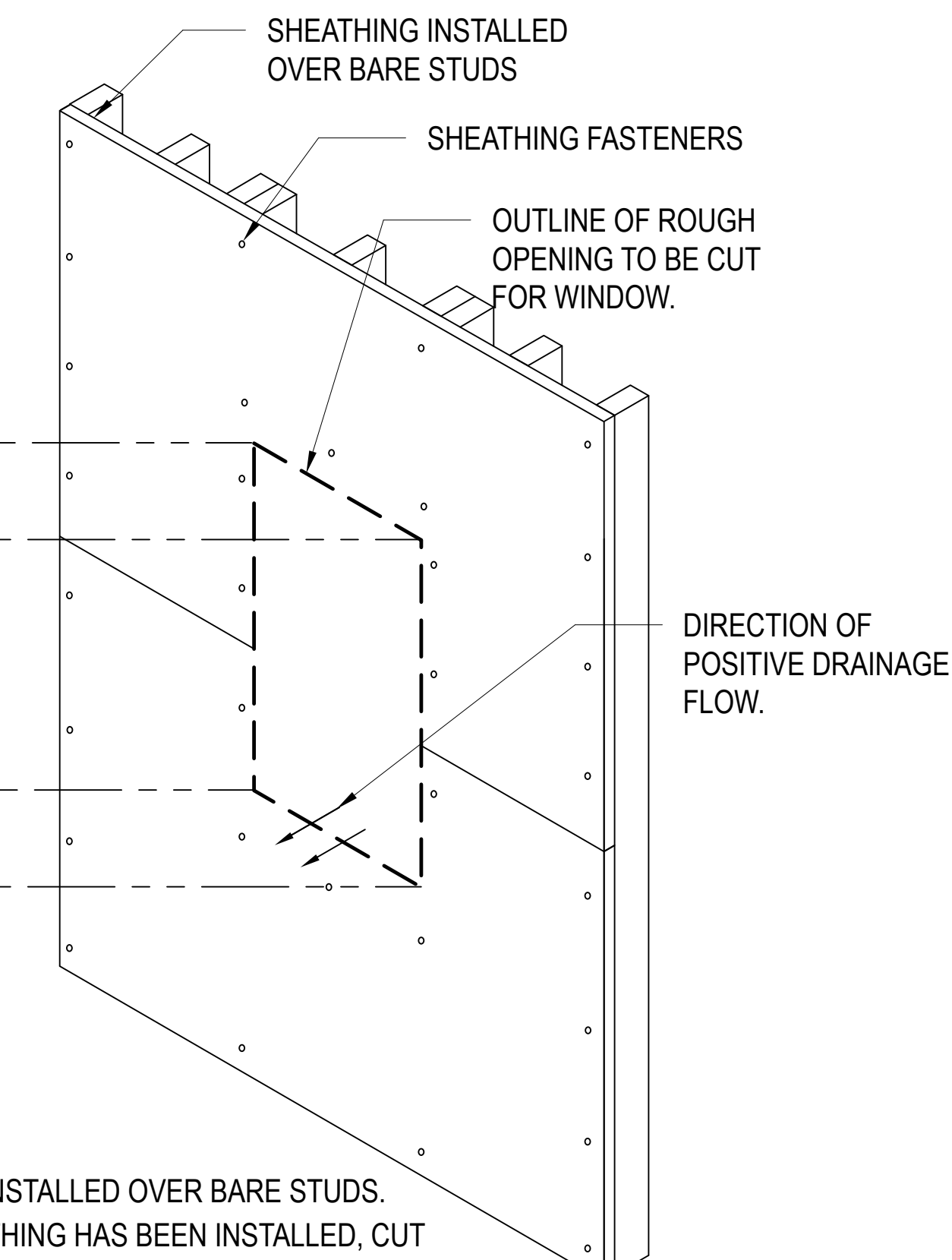

Integral Flanged Window  
Installed AFTER the  
DuPont™ Tyvek® WRB  
Installation Sequence

DRAWING:	
R-OP-2110-MA, Page 1 of 2	REVISION DATE: 7/9/2024
	SCALE: Not to Scale

DUPONT  
Tyvek



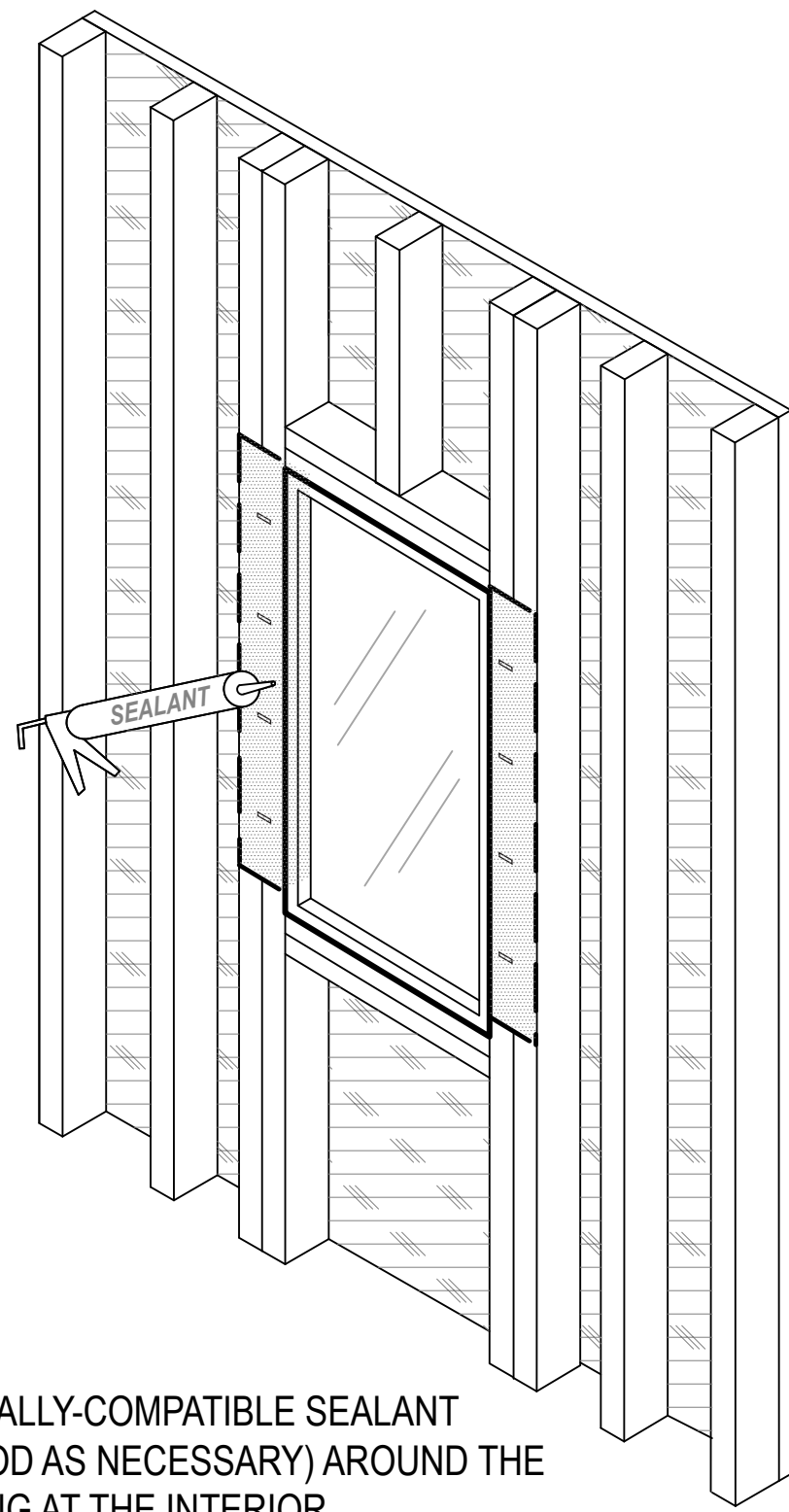

### STEP 16

- A. APPLY A CHEMICALLY-COMPATIBLE SEALANT (AND BACKER ROD AS NECESSARY) AROUND THE WINDOW OPENING AT THE INTERIOR. IT IS ALSO ACCEPTABLE TO USE GREAT STUFF PRO™ WINDOW AND DOOR POLYURETHANE FOAM SEALANT, OR A CHEMICALLY-COMPATIBLE FOAM.

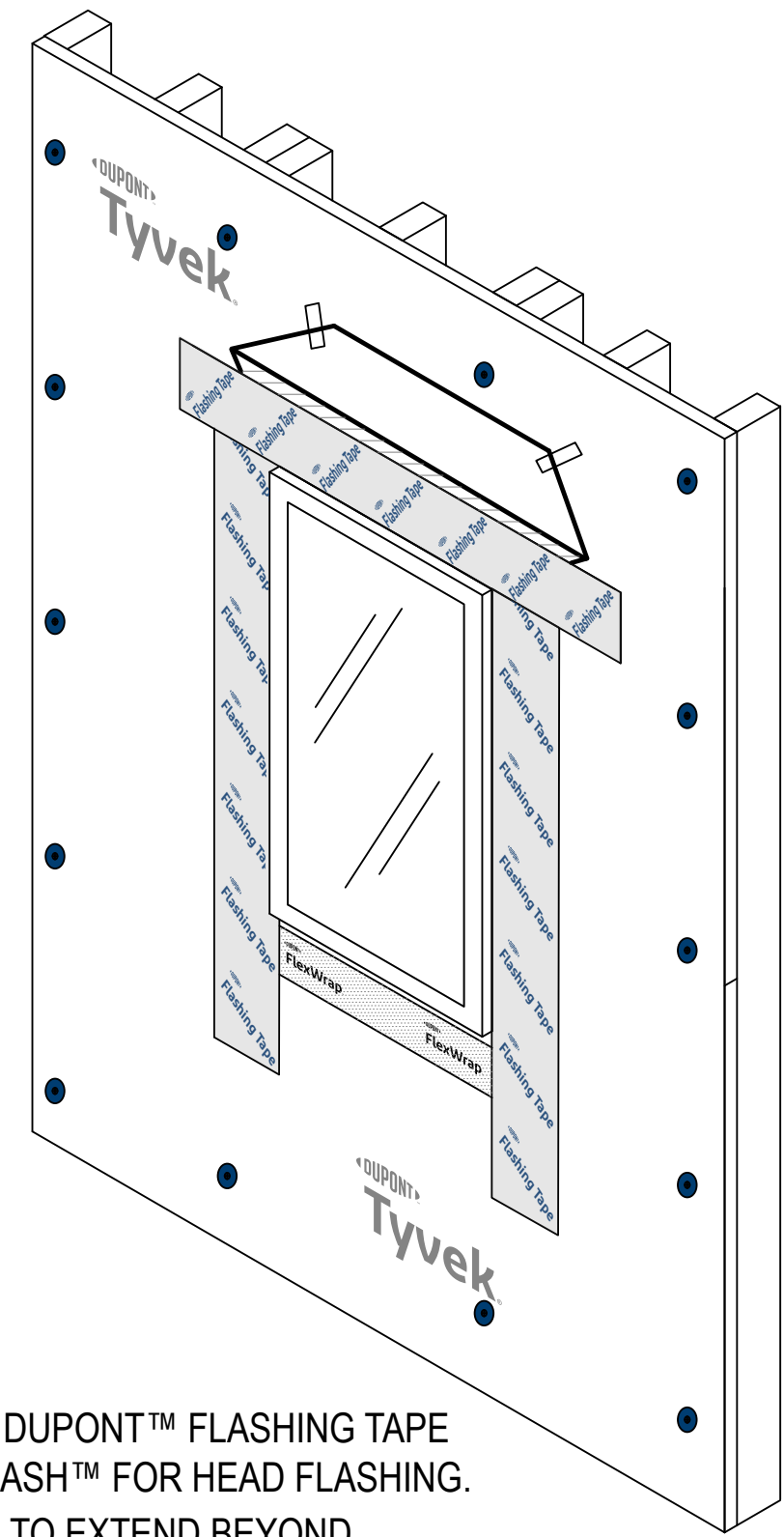

### STEP 12

- A. CUT A PIECE OF DUPONT™ FLASHING TAPE OR STRAIGHTFLASH™ FOR HEAD FLASHING.  
B. HEAD FLASHING TO EXTEND BEYOND OUTER EDGES OF JAMB FLASHING.  
C. REMOVE RELEASE PAPER AND INSTALL COMPLETELY COVERING WINDOW MOUNTING FLANGE AND ADHERING TO THE EXPOSED SHEATHING.

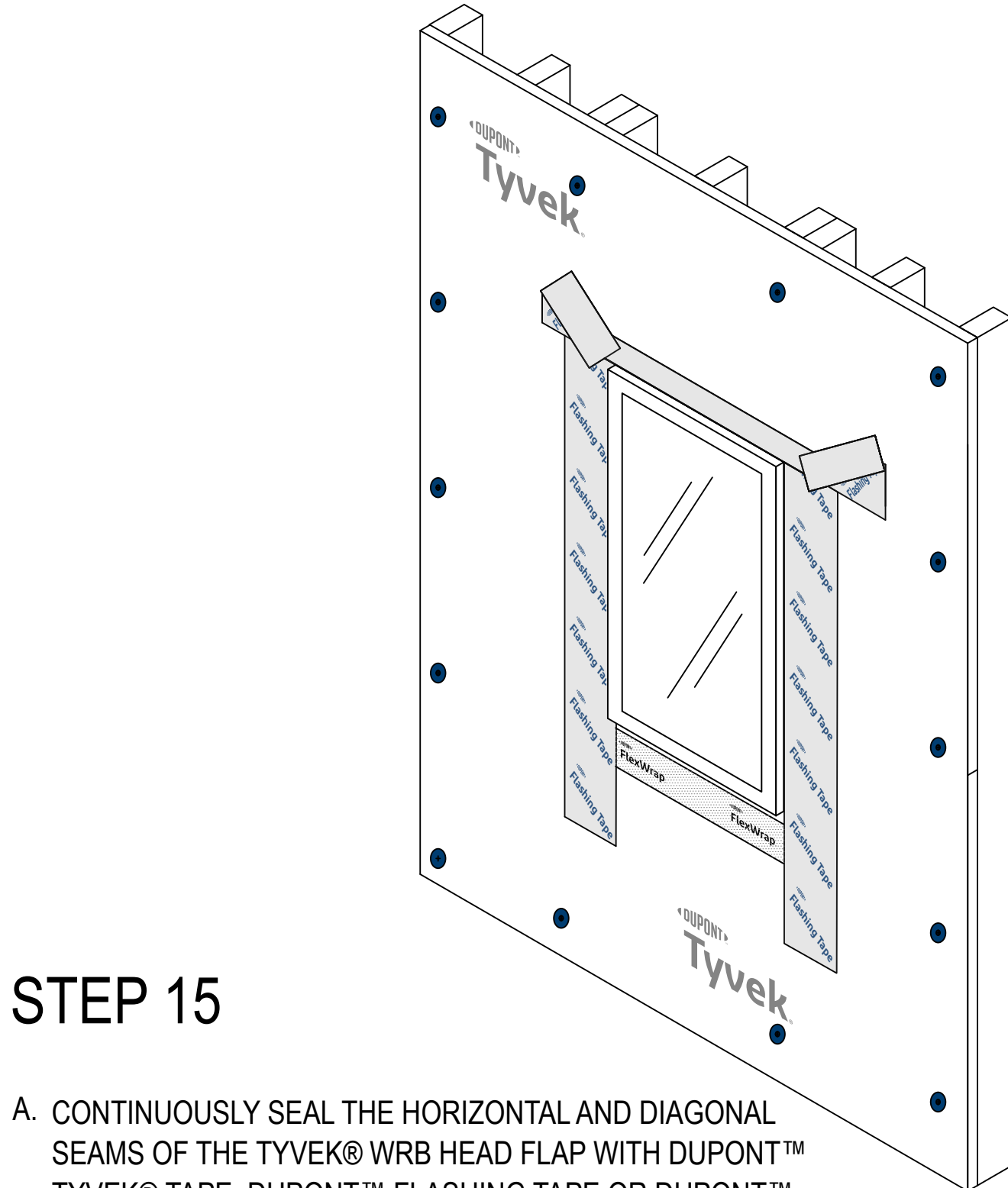

### STEP 15

- A. CONTINUOUSLY SEAL THE HORIZONTAL AND DIAGONAL SEAMS OF THE TYVEK® WRB HEAD FLAP WITH DUPONT™ TYVEK® TAPE, DUPONT™ FLASHING TAPE OR DUPONT™ STRAIGHTFLASH™. INSTALL FASTENERS AS NEEDED THROUGH FLASHING FOR INCREASED HOLDING POWER.

SKIP SEALING WITH A MAXIMUM OF TWO (2) 2" GAPS FOR EVERY 3' OF WINDOW. IS ACCEPTABLE FOR ADDITIONAL DRAINAGE IF AN AIR BARRIER IS NOT REQUIRED.

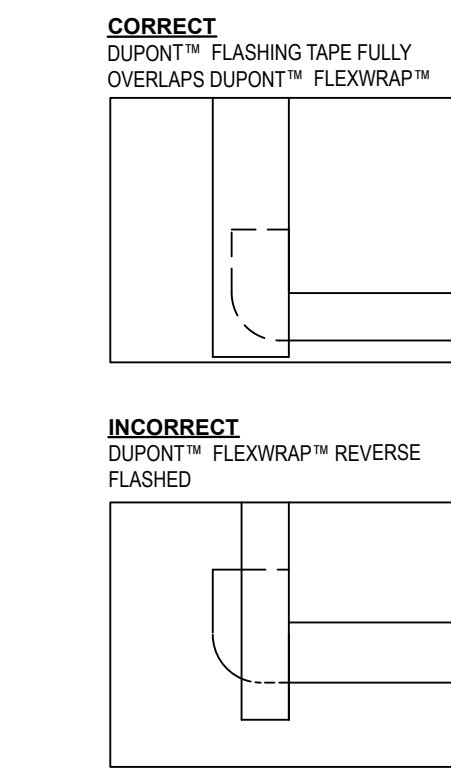

### STEP 11

- A. CUT TWO PIECES OF DUPONT™ FLASHING TAPE OR DUPONT™ STRAIGHTFLASH™ FOR JAMB FLASHING EXTENDING 1" ABOVE WINDOW HEAD FLANGE AND BELOW BOTTOM EDGE OF SILL FLASHING.  
B. REMOVE RELEASE PAPER AND PRESS TIGHTLY ALONG SIDES OF WINDOW FRAME.

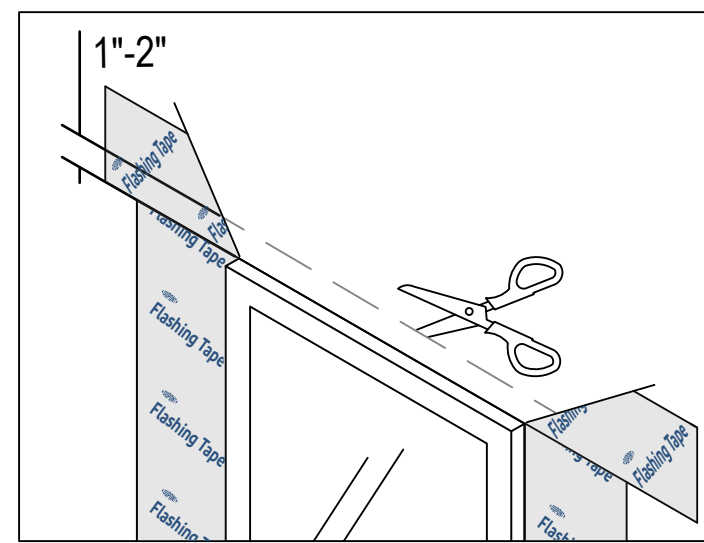
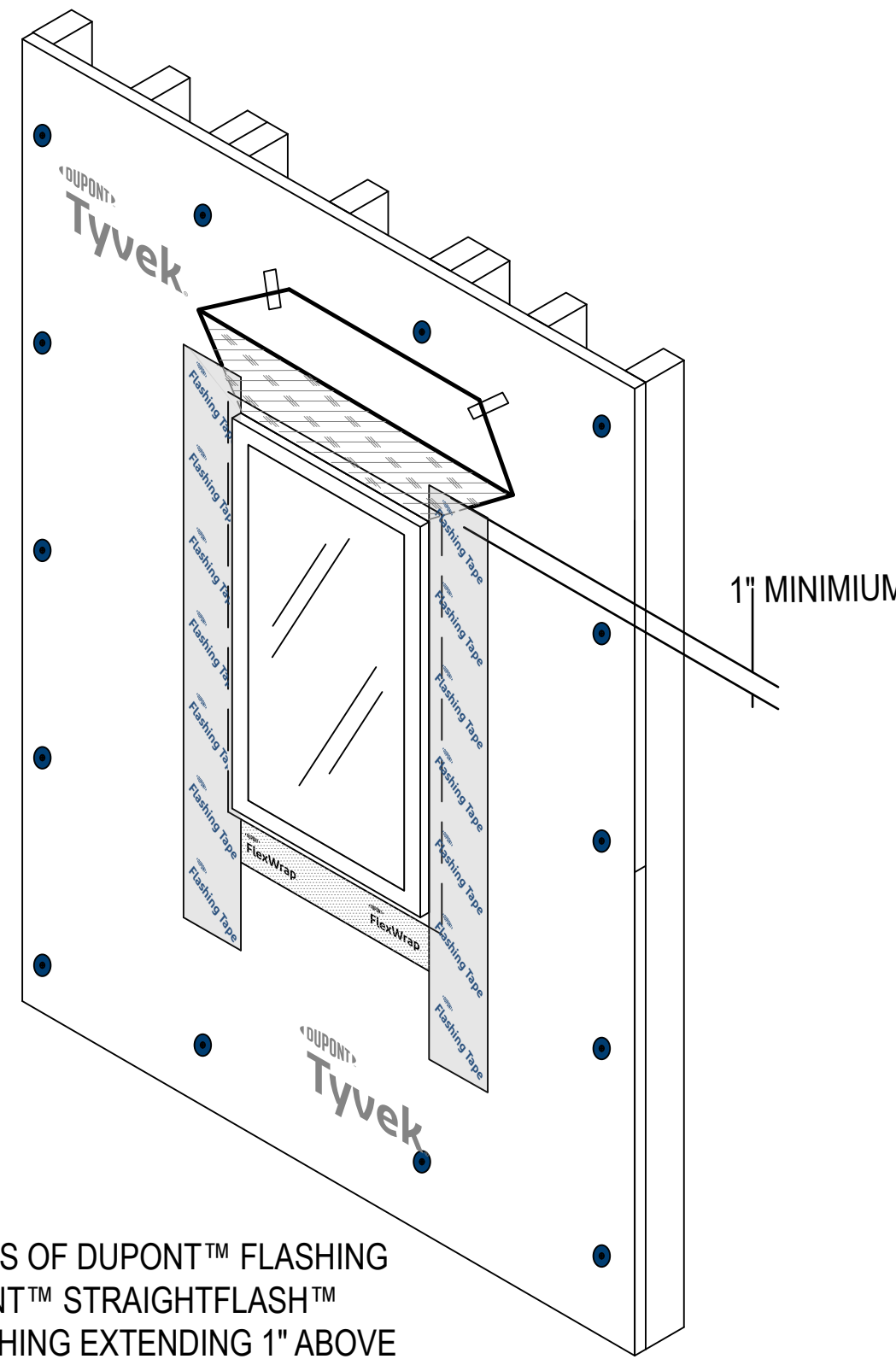

### STEP 14

- A. TRIM THE TYVEK® WRB 1"-2" ABOVE THE WINDOW OPENING.  
B. WHEN TRIMMING THE TYVEK® WRB, DO NOT CUT OR DAMAGE THE HEAD FLASHING THAT HAS BEEN INSTALLED BEHIND IT.

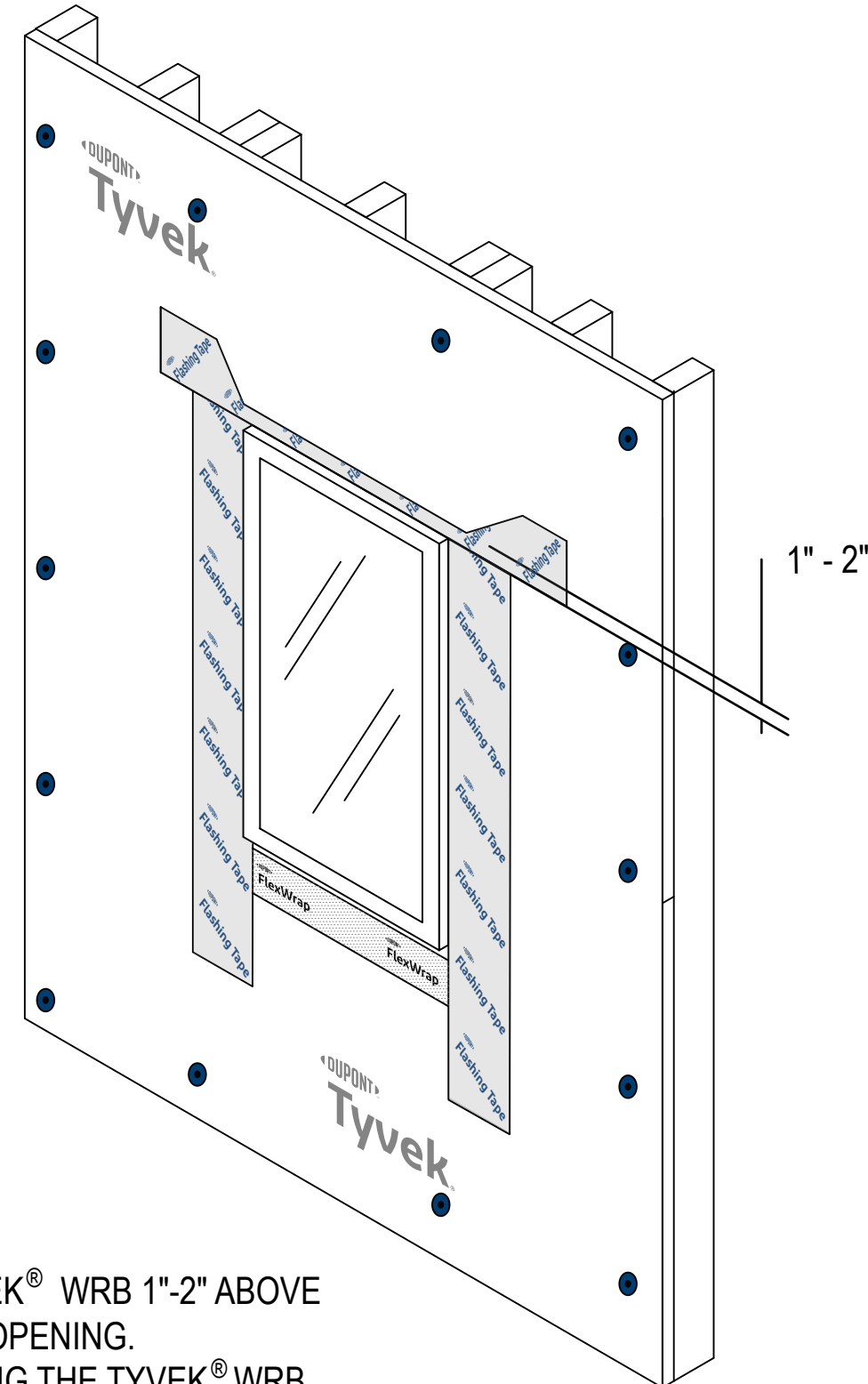

WINDOW TO BE INSTALLED

### STEP 10

- A. INSTALL WINDOW ACCORDING TO MANUFACTURER'S INSTALLATION INSTRUCTIONS.

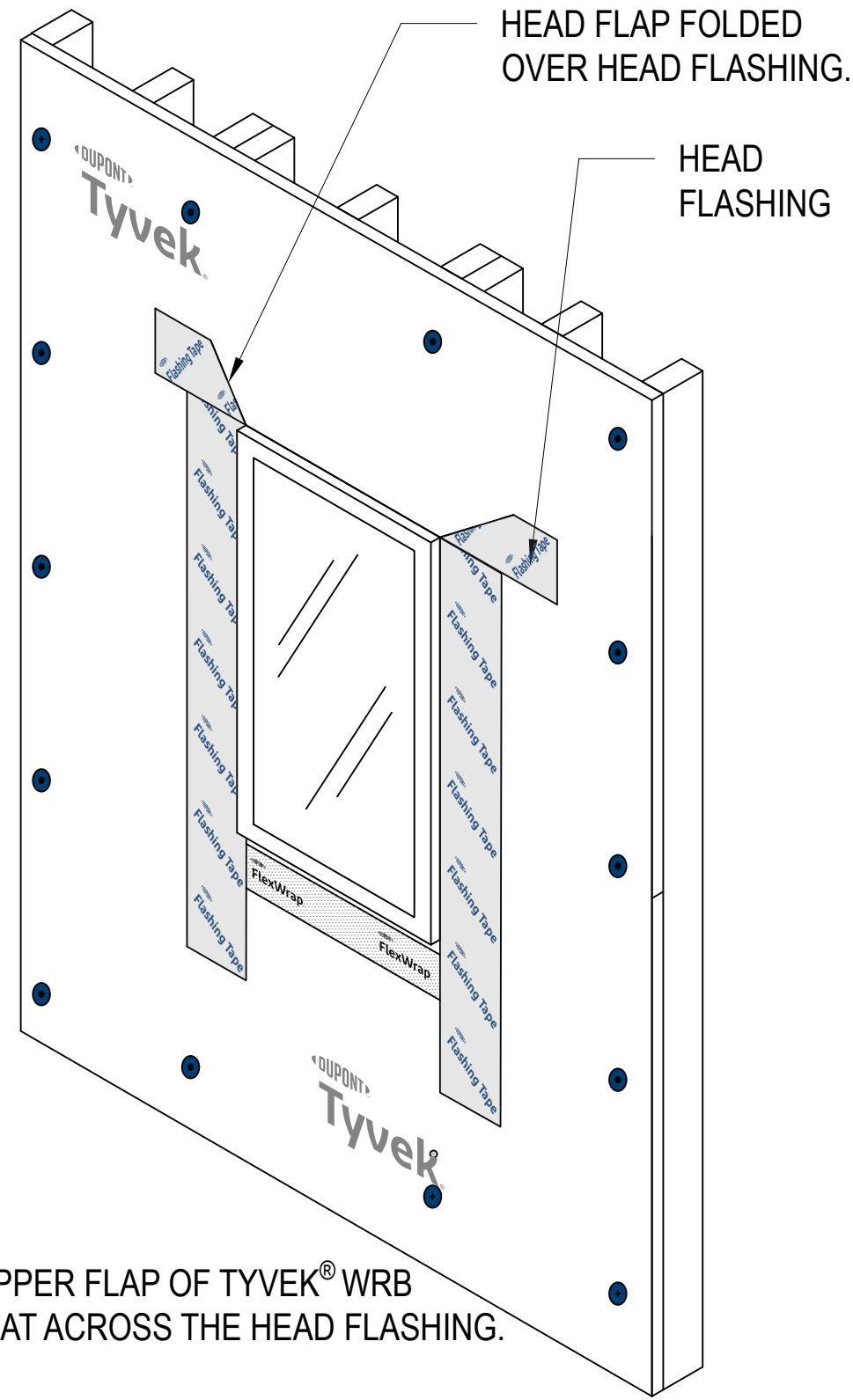
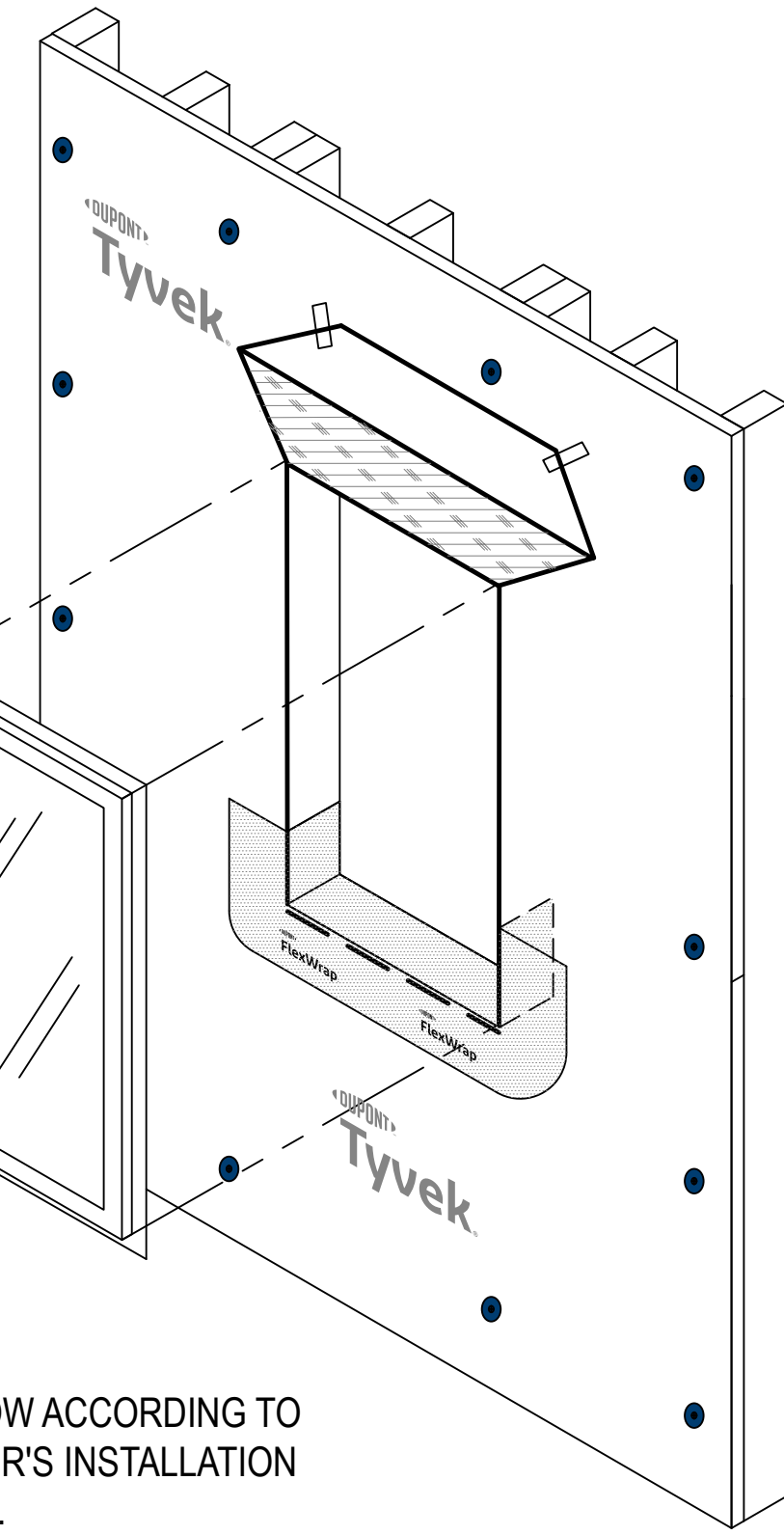

### STEP 13

- A. FLIP DOWN UPPER FLAP OF TYVEK® WRB SO IT LAYS FLAT ACROSS THE HEAD FLASHING.

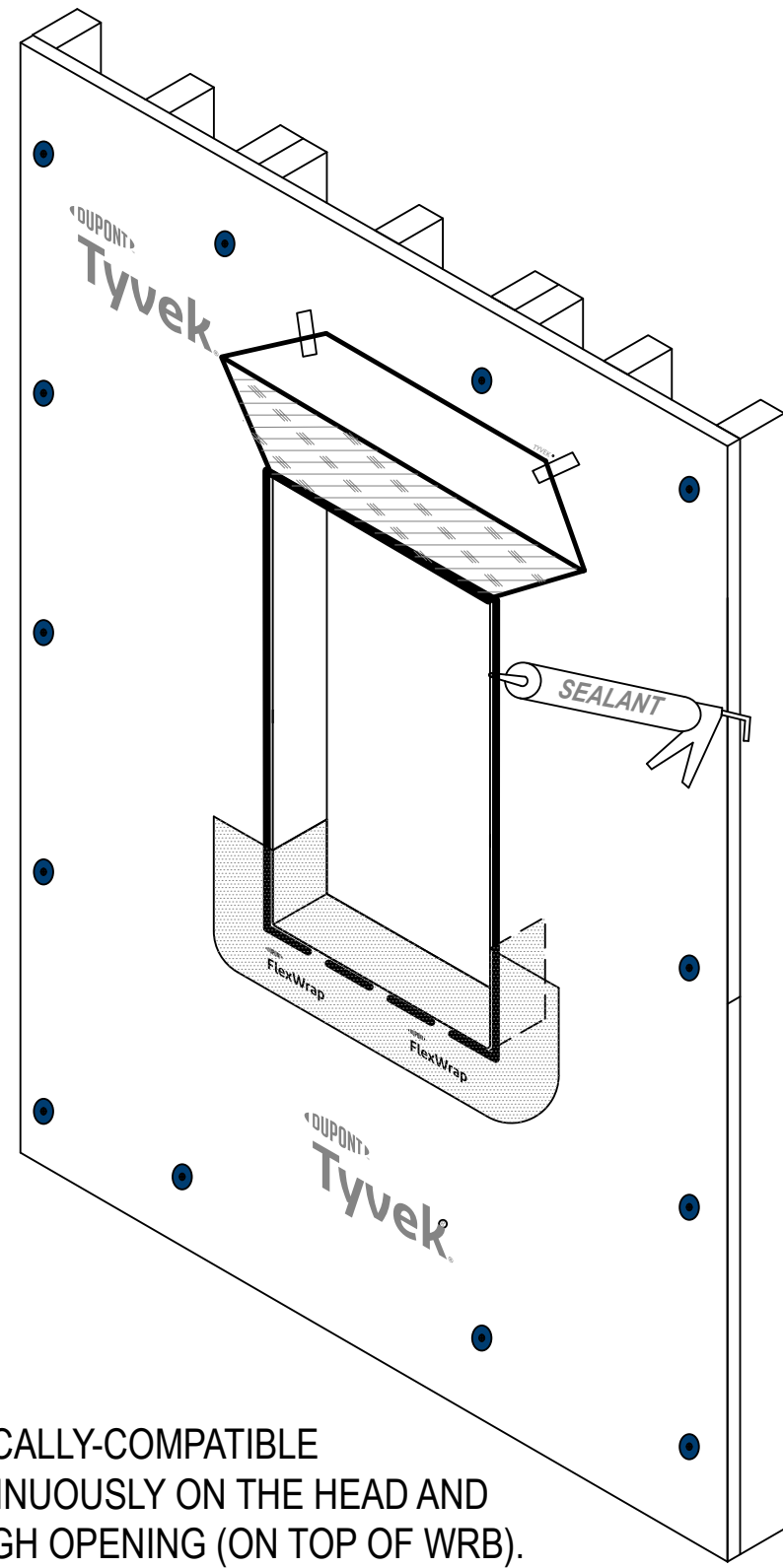

### STEP 9

- A. APPLY A CHEMICALLY-COMPATIBLE SEALANT CONTINUOUSLY ON THE HEAD AND JAMBS OF ROUGH OPENING (ON TOP OF WRB).  
B. IF SEALANT IS APPLIED TO THE SILL, ENSURE THAT THERE ARE AT LEAST TWO (2) 2" INCH GAPS IN THE SEALANT BEAD FOR EVERY 4' OF WINDOW TO ALLOW FOR DRAINAGE.

Integral Flanged Window  
Installed AFTER the  
DuPont™ Tyvek® WRB  
Installation Sequence

DRAWING:  
R-OP-2110-MA, Page 2 of 2

REVISION DATE  
7/9/2024

SCALE: Not to Scale

DUPONT  
Tyvek