

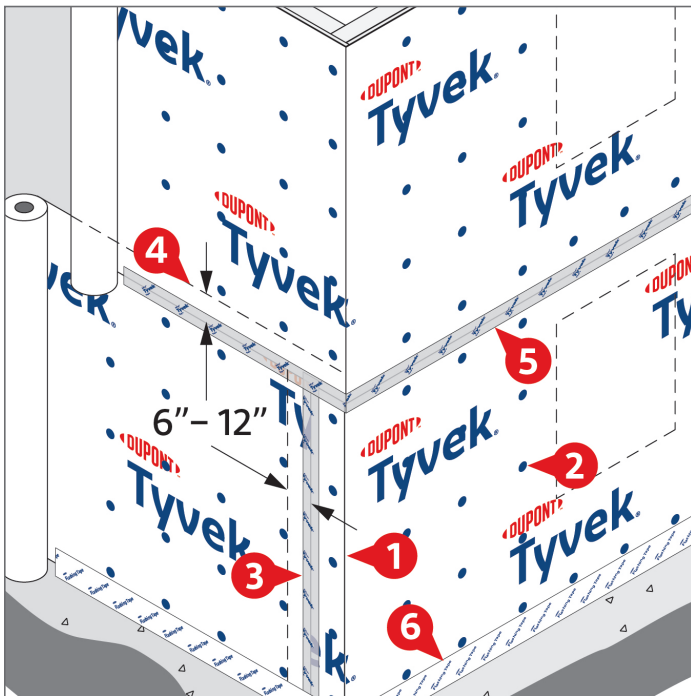

This document is designed to serve as a resource. The examples provided do not override or change any requirement in the currently published Installation Guidelines or Warranties. For complete details, always refer to the applicable Installation Guidelines and Warranties, available at www.dupont.com/building/how-to-install.html. Scan the QR code for quick and direct access.

Tyvek® WRB Installation for New Construction



1. **Tyvek® WRB** roll aligned at bottom corner of structure and unrolled starting at corner and directly over window/door rough openings. All vertical seams overlapped by 6"–12".
2. **Tyvek® WRB** secured to stud or nail-base material with recommended fasteners spaced 6"–18" on vertical stud lines. No fasteners within 6" of sills and jams and 9" of the head of window/door rough openings.
3. Vertical seams of **Tyvek® WRB** taped with **DuPont™ Tyvek® Tape**.
4. Upper layer of **Tyvek® WRB** installed overlapping bottom layer by min. 6".
5. **Air Barrier Installations:** All horizontal seams taped. (3" **Tyvek® Tape** required on horizontal and vertical seams when using **DuPont™ Tyvek® StuccoWrap®**, **Tyvek® DrainWrap™** or **Tyvek® CommercialWrap® D**).
6. **Air Barrier Installations:** All terminations of the **Tyvek® WRB** (including, but not limited to, top-of-wall/bottom-of-wall interfaces) taped or sealed with **Tyvek® Tape** or **DuPont Self-Adhered Flashing Products**. See *Base of Wall* section for more options

Recommended Fasteners (non-exhaustive list):

- **DuPont™ Tyvek® Wrap Cap** Nails, Screws, or Staples
- Other cap staples for Stinger® Cap Stapler
- TRUFast® Walls Grip-Deck® screws with Thermal-Grip FastCap™ washers (TRUFast® Walls formerly Rodenhouse).

Base of Wall

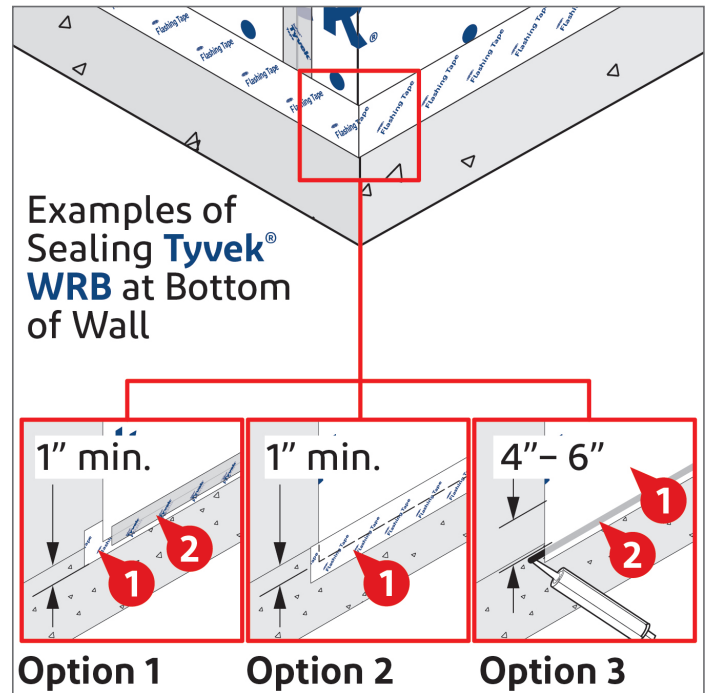

Option 1

1. Interface of sheathing and foundation sealed using **DuPont Self-Adhered Flashing Product**.
2. **Tyvek® WRB** overlapped onto **DuPont Self-Adhered Flashing Product** min. 1" and terminated using **Tyvek® Tape**^[1].

Option 2

1. **Tyvek® WRB** overlapped onto foundation min. 1" and sealed with **DuPont Self-Adhered Flashing Product**^[1].

Option 3

1. Ensure **Tyvek® WRB** overlaps foundation min 1".
2. Apply a liberal bead of Tower® Residential Sealant, or recommended sealant, along top edge of foundation.
3. **Tyvek® WRB** overlapped onto foundation and into sealant

^[1] **DuPont Self-Adhered Flashing Products** with a recommended primer, as applicable when **Tyvek® WRB** sealed directly to gypsum sheathing, concrete, wood or other rough surfaces.



This document is designed to serve as a resource. The examples provided do not override or change any requirement in the currently published Installation Guidelines or Warranties. For complete details, always refer to the applicable Installation Guidelines and Warranties, available at www.dupont.com/building/how-to-install.html. Scan the QR code for quick and direct access.

Sealing Non-Flanged Penetrations with DuPont™ FlexWrap™

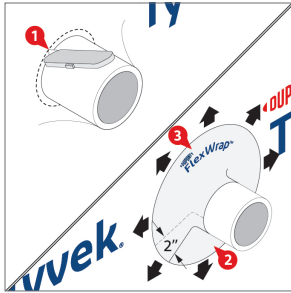

Method 1

1. **Tyvek® WRB** cut around penetration.
2. **FlexWrap™** installed around bottom of penetration.
3. **FlexWrap™** installed around top of penetration, overlapping bottom layer of **FlexWrap™** by 2" on either side.
4. **OPTIONAL:** Piece of **Tyvek® WRB** taped over top of **FlexWrap™** (not shown).

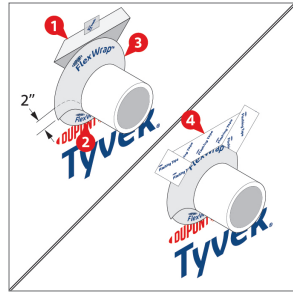

Method 2

1. **Tyvek® WRB** cut around penetration with head flap cut above.
2. **FlexWrap™** installed around bottom of penetration.
3. **FlexWrap™** installed around top of penetration, overlapping bottom layer of **FlexWrap™** by 2" on either side.
4. Head flap sealed using **DuPont™ Tyvek® Tape** or **DuPont Self-Adhered Flashing Products**.

Sealing Penetrations with DuPont™ FlexWrap™ EZ

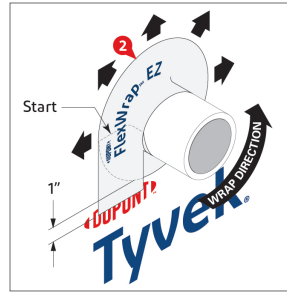

Outer Diameter GREATER than 2"

1. **FlexWrap™ EZ** piece cut **LONGER** than the circumference of non-flanged product (ensure 1" overlap onto the **Tyvek® WRB**).
2. **FlexWrap™ EZ** adhered around penetration, starting at the horizontal position on either side.

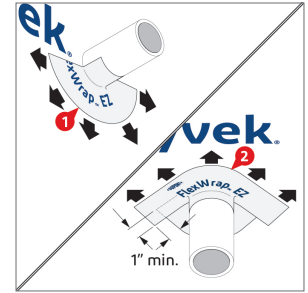

Outer Diameter LESS than 2"

1. **FlexWrap™ EZ** piece cut 1/2 the length of the circumference of the non-flanged product, adhered onto bottom section, and fanned out onto **Tyvek® WRB**.
2. Second piece of **FlexWrap™ EZ** piece cut the length of the pipe circumference, adhered onto top section and fanned out onto face of wall with a min 1" overlap of the edges of the **FlexWrap™ EZ** below.

Flanged Penetration BEFORE Tyvek® WRB

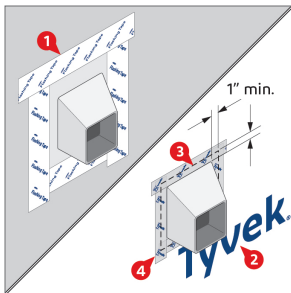

Method 1

1. **DuPont™ Flashing Tape** installed onto flanges extending onto sheathing by min. 2".
2. **Tyvek® WRB** installed on wall.
3. **Tyvek® WRB** cut around penetration, ensuring min. 1" gap for adhesion.
4. Edges of **Tyvek® WRB** sealed with **Tyvek® Tape**.

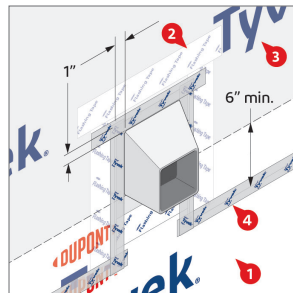

Method 2

1. **Tyvek® WRB** installed under bottom flange.
2. **DuPont™ Flashing Tape** adhered onto sides and top flange.
3. Next course of **Tyvek® WRB** installed with min. 6" overlap.
4. **Tyvek® WRB** seams sealed with **Tyvek® Tape**.

Flanged Penetration AFTER Tyvek® WRB

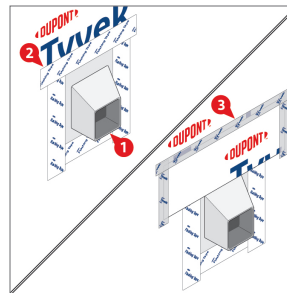

Method 1

1. Integral flanged product installed.
2. **DuPont Self-Adhered Flashing Product** or **Tyvek® Tape** installed onto bottom, sides, and top flanges, extending onto **Tyvek® WRB** min. 2".
3. **OPTIONAL:** **Tyvek® WRB** piece installed to overlap the top edge of the **DuPont Self-Adhered Flashing Product**. Sides and top sealed with **Tyvek® Tape**.

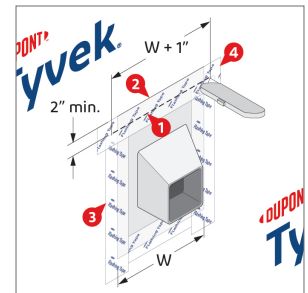

Method 2

1. Horizontal cut min. 1" wider than the flange.
2. Top flange slid into slit with min. 2" overlap of **Tyvek® WRB**.
3. **DuPont Self-Adhered Flashing Product** (recommended best practice) or **Tyvek® Tape** adhered on bottom and side flanges, extending onto **Tyvek® WRB** by 2".
4. **DuPont Self-Adhered Flashing Product** (recommended best practice) or **Tyvek® Tape** installed to top flange, extending **BEYOND DuPont Self-Adhered Flashing Product**, or **Tyvek® Tape**, on side flanges.



This document is designed to serve as a resource. The examples provided do not override or change any requirement in the currently published Installation Guidelines or Warranties. For complete details, always refer to the applicable Installation Guidelines and Warranties, available at www.dupont.com/building/how-to-install.html. Scan the QR code for quick and direct access.

Wall Protrusion with Horizontal Plane

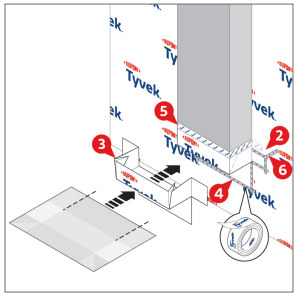

1. Tyvek® WRB terminated below horizontal plane onto sheathing using **DuPont Self-Adhered Flashing Product** (not shown). Termination optional for horizontal planes 12" or less.
2. At outside edge of cantilever, flap cut min. 6" above bottom edge of horizontal plane.
3. Tyvek® WRB wrapped under horizontal plane and folded up the sides of wall protrusion min. 6".
4. All Tyvek® WRB seams sealed with **DuPont™ Tyvek® Tape**.
5. Top edge of Tyvek® WRB sealed to the sheathing using **DuPont™ Flashing Tape**.
6. Flap at outside edges of horizontal plane folded down and sealed with Tyvek® Tape.
7. Upper course of Tyvek® WRB installed overlapping bottom layer min 6" (not shown).

Horizontal Plane Transition

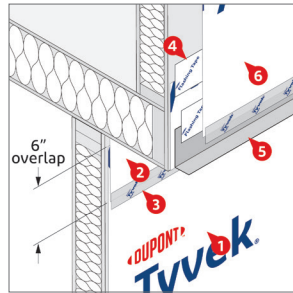

1. Tyvek® WRB installed on wall below horizontal plane.
2. Tyvek® WRB installed on horizontal plane, overlapping the Tyvek® WRB below by 6", and extending min. 6" onto the vertical wall above.
3. Tyvek® Tape applied to seal horizontal seam below.
4. **DuPont™ Flashing Tape** applied to terminate Tyvek® WRB onto sheathing above horizontal plane.
5. **OPTIONAL:** Install a kick-out flashing and terminate vertical leg with **DuPont™ Flashing Tape**.
6. Tyvek® WRB installed on wall above horizontal plane and terminated onto kick-out flashing with Tyvek® Tape or **DuPont Self-Adhered Flashing Product**.

Façade Transition

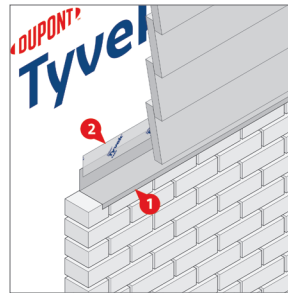

Option 1 Metal Flashing Sealed to Tyvek® WRB

1. No Tyvek® WRB fasteners where metal flashing or **DuPont Self-Adhered Flashing** will be installed. "Z" or "L" metal flashing installed over lower façade and fastened onto Tyvek® WRB with mechanical fasteners.
2. Vertical leg of metal flashing terminated to Tyvek® WRB with **DuPont™ Flashing Tape** or Tyvek® Tape. When using **DuPont™ Flashing Tape**, ensure min. 2" adhesion to the WRB.

Option 2 Metal Flashing Sealed to Sheathing

1. First course of Tyvek® WRB installed with min. 2" extending **BEYOND** where top edge of the lower façade will be located.
2. "Z" or "L" metal flashing applied over lower façade, even with top edge of Tyvek® WRB, and fastened with mechanical fasteners.
3. Vertical leg of metal flashing terminated to sheathing with **DuPont™ Flashing Tape** with min. 2" adhesion onto sheathing.
4. Next course of Tyvek® WRB installed with min. 2" overlap onto **DuPont Self-Adhered Flashing Product**. WRB terminated to self-adhered flashing using Tyvek® Tape.

Beam Penetration

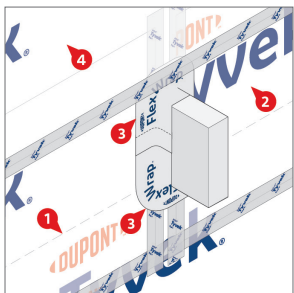

1. Tyvek® WRB installed across wall with top edge of WRB at bottom of beam.
2. Two pieces of Tyvek® WRB installed on either side of beam and sealed with Tyvek® Tape. The two pieces extend min. 7" above top of beam and overlap lower WRB course min. 6".
3. First piece of **DuPont™ FlexWrap™** installed around bottom of penetration before second piece installed around top of penetration, overlapping bottom layer by 2".
4. Tyvek® WRB installed above beam, overlapping lower courses with 1" gap above beam. All horizontal and vertical seams taped with Tyvek® Tape.

Integrating Tyvek® WRB for Windows/Doors Installed BEFORE Tyvek® WRB

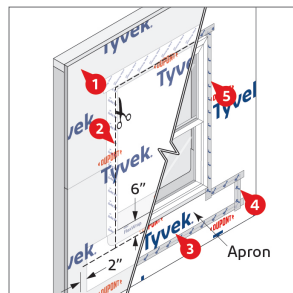

1. Tyvek® WRB installed over window/door. No fasteners within 4" of frame of window at jambs/head and within 12" at sill.
2. Perimeter marked 1" – 2" from window at jambs/head and 6" below window at sill. Cut along marking to expose window. Slits cut at lower corners 1" – 2" **BEYOND** Tyvek® WRB apron underneath.
3. Tyvek® WRB apron brought to the front through the cut/slits and lapped over top layer of Tyvek® WRB.
4. Tyvek® WRB apron sealed around perimeter with Tyvek® Tape.
5. Tyvek® WRB terminated around window with Tyvek® Tape or **DuPont Self-Adhered Flashing**.

Handling Tears

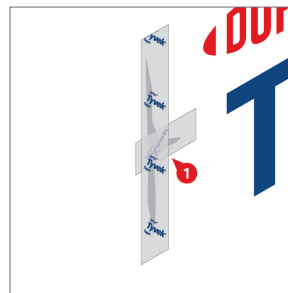

1. Tears covered with Tyvek® Tape or **DuPont Self-Adhered Flashing Products**.

Handling Holes

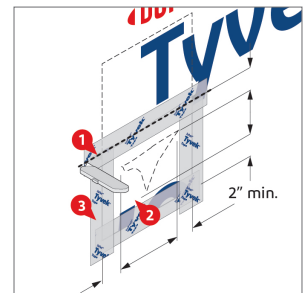

1. Slit in Tyvek® WRB cut 2" above hole and extending 2" on each side of hole.
2. Piece of Tyvek® WRB tucked into the slit to maintain proper shingling.
3. Seams around Tyvek® WRB taped, working from bottom to top.

Single-Family Field Installation Examples: DuPont Self-Adhered Flashing Products (Installed AFTER DuPont™ Tyvek® WRB)

This document is designed to serve as a resource. The examples provided do not override or change any requirement in the currently published Installation Guidelines or Warranties. For complete details, always refer to the applicable Installation Guidelines and Warranties, available at www.dupont.com/building/how-to-install.html. Scan the QR code for quick and direct access.

•DUPONT•

Tyvek®



Integral Flanged Window

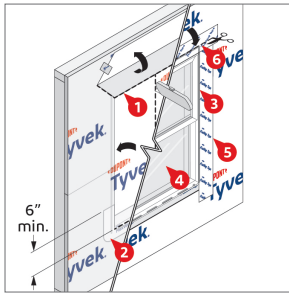

1. "I-Cut" in **Tyvek® WRB** at rough openings. 45° cuts at window head extending min. 8" from outer corners. Flaps at jambs folded into the opening and secured. Head flap flipped up and secured.
2. **DuPont™ FlexWrap™** installed at the sill and min. 6" up jambs.
3. Sealant applied to three sides of the window opening at jambs and head.
OPTIONAL: Skip sealing at the sill for drainage.
4. Window installed per manufacturer's specifications.
5. **DuPont™ Flashing Tape** applied over flanges at jambs and head.
6. Head flap trimmed 1"–2" and secured overhead flashing with **DuPont™ Tyvek® Tape** or **DuPont Self-Adhered Flashing Product**.
7. Full interior perimeter seal applied (not shown).

Integral Flanged Adjacent Windows

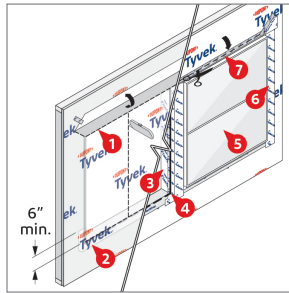

1. "I-Cut" in **Tyvek® WRB** at rough openings. 45° cuts at window head extending min. 8" from outer corners. Flaps at jambs folded into the opening and secured. Head flap flipped up and secured.
2. **FlexWrap™** installed at each sill extending min. 6" up jambs.
3. 9" **DuPont™ Flashing Tape** installed onto shared vertical framing; bottom edge aligned with sill, top edge aligned with head.
NOTE: For option using **Tyvek® WRB** at shared framing – see full Single-Family Install Guides.
4. Sealant applied to three sides of the window opening at jambs and head.
OPTIONAL: Skip sealing at the sill for drainage.
5. Window installed per manufacturer's specifications.
6. **DuPont™ Flashing Tape** applied over flanges at jambs and head.
7. Head flap trimmed 1"–2" and secured over head flashing with **Tyvek® Tape** or **DuPont Self-Adhered Flashing Products**.
8. Full interior perimeter seal applied to both windows (not shown).

Non-Flanged Door using DuPont™ VersaFlange™

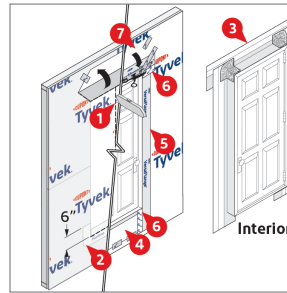

Method also applies to Non-flanged window, non-integral flanged window/door, and brick mold window/door.

1. "I-Cut" in **Tyvek® WRB** at rough openings. 45° cuts at window head extending min. 8" from outer corners. Flaps at jambs folded into the opening and secured. Head flap flipped up and secured.
2. **FlexWrap™** installed at sill extending min. 6" up jambs. Integrated back dam as applicable.
3. **VersaFlange™** applied to door frame along jambs and head (head piece installed first). **FlexWrap™** pieces applied at corners.
4. **OPTIONAL:** For higher performance, high-pressure skirt installed to door frame prior to door installation.
5. Release paper removed from **VersaFlange™** and door installed per manufacturer's instructions.
6. **OPTIONAL:** Exposed butyl covered with **Tyvek® Tape** or **DuPont Self-Adhered Flashing Products**.
7. Head flap flipped down, trimmed 1"–2", and sealed with **Tyvek® Tape** or **DuPont Self-Adhered Flashing Products**.
8. Full interior perimeter seal applied (not shown).

Packaged Terminal Air Conditioner (PTAC) Unit

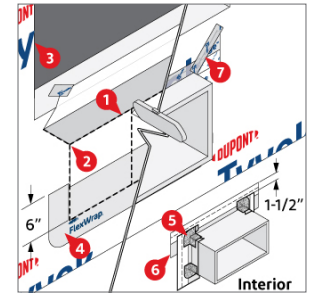

1. "I-Cut" in **Tyvek® WRB** at PTAC rough opening. Flaps at jambs folded into the opening and secured.
2. **Tyvek® WRB** above PTAC opening cut according to distance between window and PTAC:
 - a. **When PTAC opening min. 8" below window:** 45° cuts at window head extending min. 8" from outer corners. Head flap flipped up and secured.
 - b. **When PTAC opening less than 8" below window:** Two vertical cuts in **Tyvek® WRB** above PTAC opening, cuts aligned with jambs, to remove **Tyvek® WRB** piece.
3. For integral flanged window above PTAC, "I-Cut" and head flap cut in **Tyvek® WRB** for window opening.
4. **FlexWrap™** installed at PTAC sill extending min. 6" up jambs.
5. **DuPont™ VersaFlange™** applied to PTAC sleeve along jambs and head (head piece installed first). **FlexWrap™** pieces applied at four corners.
6. Release paper removed from **VersaFlange™** and PTAC sleeve installed.
7. PTAC opening on face of wall finished according to distance between window and PTAC:
 - a. **When PTAC opening min. 8" below window:** Head flap flipped down, trimmed 1"–2", and sealed with **Tyvek® Tape** or **DuPont Self-Adhered Flashing Products**.
 - b. **When PTAC opening less than 8" below window:** Only if additional exposed sheathing above **VersaFlange™** head flashing - additional piece of **DuPont Self-Adhered Flashing Product** applied flush with window sill.
8. Install window according to manufacturer's instructions and flash per applicable DuPont Installation Guidelines (not shown).
9. Full interior perimeter seal applied to both PTAC and window opening (not shown).

Drip Cap Installation for Windows and Doors

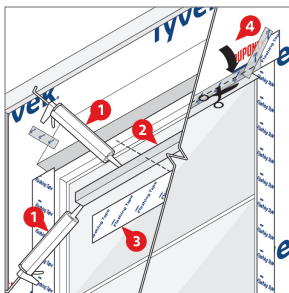

Option 1 Drip Cap Under Head Flap, Single Piece of Flashing — Requires Drip Cap Leg NOT Taller than Window Flange

1. Sealant applied to both sides of drip cap.
2. Drip cap installed tight against window head flange.
3. **DuPont™ Flashing Tape** installed over drip cap and head flange.
4. Head flap flipped down, trimmed 1"–2", and sealed with **Tyvek® Tape** or **DuPont Self-Adhered Flashing Products**.

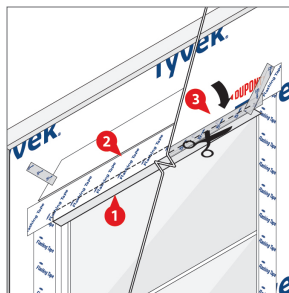

Option 2 Drip Cap Under Head Flap, Over Window Head Flashing

1. Drip cap installed tight against window head flange.
2. **DuPont™ Flashing Tape** installed over drip cap top edge.
3. Head flap flipped down, trimmed 1"–2", and sealed with **Tyvek® Tape** or **DuPont Self-Adhered Flashing Products**.

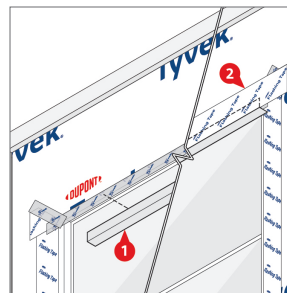

Option 3 Drip Cap Over Head Flap

1. Drip cap installed tight against window head flange.
2. **DuPont™ Flashing Tape** installed over drip cap top edge.

Single-Family Field Installation Examples: DuPont Self-Adhered Flashing Products (Installed AFTER DuPont™ Tyvek® WRB)



This document is designed to serve as a resource. The examples provided do not override or change any requirement in the currently published Installation Guidelines or Warranties. For complete details, always refer to the applicable Installation Guidelines and Warranties, available at www.dupont.com/building/how-to-install.html. Scan the QR code for quick and direct access.

Garage Doors

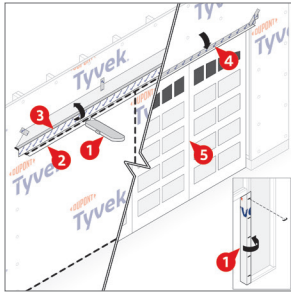

Option 1 Standard I-Cut with Drip Cap Sealed to Sheathing

1. "I-Cut" in **Tyvek® WRB** at rough openings. 45° cuts at head of garage door frame extending min. 8" from outer corners. Flaps at jambs folded into the opening and secured. Head flap flipped up and secured.
2. Metal or vinyl drip cap installed.
3. Head flange and top edge of the drip cap covered with a piece of **DuPont™ Flashing Tape** or **DuPont™ StraightFlash™**.
4. Head flap trimmed 1"– 2" and secured overhead flashing with **DuPont™ Tyvek® Tape** or **DuPont Self-Adhered Flashing Products**.
5. Garage door installed per manufacturer's installation instructions.

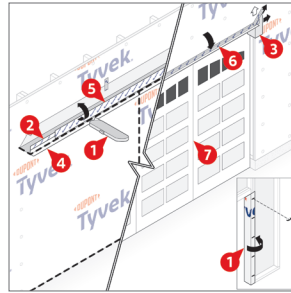

Option 2 I-Cut and Three-Piece Head Detail with Drip Cap Sealed Over Flashing

1. "I-Cut" in **Tyvek® WRB** at rough openings. 45° cuts at head of garage door frame extending min. 8" from outer corners. Flaps at jambs folded into the opening and secured. Head flap flipped up and secured.
2. **DuPont™ Flashing Tape** or **StraightFlash™** installed first onto flat part of the head, then onto the sheathing on the face of the wall above.
3. **DuPont™ FlexWrap™** installed at the corners with at least 6" down the jamb and 6" onto the **DuPont™ Flashing Tape** along the head.
4. Metal or vinyl drip cap installed.
5. Head flange and top edge of the drip cap covered with a piece of **DuPont™ Flashing Tape** or **StraightFlash™**.
6. Head flap trimmed 1"– 2" and secured overhead flashing with **Tyvek® Tape** or **DuPont Self-Adhered Flashing Products**.
7. Garage door installed per manufacturer's installation instructions.

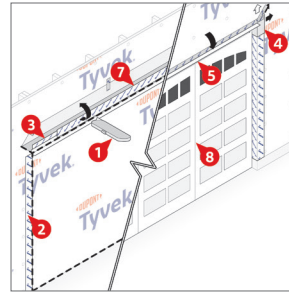

Option 3 Flush Cut (O-Cut) and "Wrap the Cavity" Flashing Method with Drip Cap Sealed Over Flashing

1. **Tyvek® WRB** cut using a square cut around the perimeter of the rough opening (not shown) and 45° at corners to create head flap.
2. **DuPont™ Flashing Tape** or **StraightFlash™** installed along the jambs.
3. **DuPont™ Flashing Tape** or **StraightFlash™** installed first onto flat part of the head, then onto the sheathing on the face of the wall above.
4. **FlexWrap™** installed at the corners with at least 6" down the jamb and 6" onto the **DuPont™ Flashing Tape** along the head.
5. Metal or vinyl drip cap installed.
6. Head flange and top edge of the drip cap covered with a piece of **DuPont™ Flashing Tape** or **StraightFlash™**.
7. Head flap trimmed 1"– 2" and secured overhead flashing with **Tyvek® Tape** or **DuPont Self-Adhered Flashing Products**.
8. Garage door installed per manufacturer's installation instructions.



**For more information, contact your
local DuPont™ Tyvek® Specialist,
visit building.dupont.com,
or call 1-833-338-7668**

NOTICE: No freedom from any patent owned by DuPont or others is to be inferred. Because use conditions and applicable laws may differ from one location to another and may change with time, Customer is responsible for determining whether products and the information in this document are appropriate for Customer's use and for ensuring that Customer's workplace and disposal practices are in compliance with applicable laws and other government enactments. The product shown in this literature may not be available for sale and/or available in all geographies where DuPont is represented. The claims made may not have been approved for use in all countries or regions. DuPont assumes no obligation or liability for the information in this document. References to "DuPont" or the "Company" mean the DuPont legal entity selling the products to Customer unless otherwise expressly noted. NO EXPRESS WARRANTIES ARE GIVEN EXCEPT FOR ANY APPLICABLE WRITTEN WARRANTIES SPECIFICALLY PROVIDED BY DUPONT. ALL IMPLIED WARRANTIES INCLUDING THOSE OF MERCHANTABILITY AND FITNESS FOR A PARTICULAR PURPOSE ARE EXPRESSLY EXCLUDED. The buyer assumes all risks as to the use of the material. Buyer's exclusive remedy or any claim (including without limitations, negligence, strict liability, or tort) shall be limited to the refund of the purchase price of the material. Failure to strictly adhere to any recommended procedures shall release DuPont de Nemours, Inc. or its affiliates of all liability with respect to the materials or the use thereof. The information herein is not intended for use by non-professional designers, applicators or other persons who do not purchase or utilize this product in the normal course of their business.

DuPont believes this information to be reliable and accurate. The information may be subject to revision as additional experience and knowledge is gained. It is the user's responsibility to determine the proper construction materials needed.

DuPont™, the DuPont Oval Logo, and all trademarks and service marks denoted with™, SM or ® are owned by affiliates of DuPont de Nemours, Inc. unless otherwise noted. © 2023 DuPont.

Document Version: March 2023

43-D100855-enNA-0223 CDP