

# DuPont™ Tyvek® IntegrationWrap™

A Durable Membrane to Integrate Weatherization Components at Rough Openings

## FEATURES/BENEFITS

### Description

DuPont™ Tyvek® IntegrationWrap® is a coated woven polypropylene membrane that connects or “integrates” DuPont Self-Adhered Flashing Products at the window/door with the DuPont™ Tyvek® WRB on the wall in single-family residential and wood-framed multi-family/light commercial construction. This flashing integration membrane helps provide an easy means of preparing rough openings prior to the installation of the primary Tyvek® WRB, which can help reduce building dry-in times and facilitate the sequence of trades during the construction process.

### Key Features

- Flashing integration membrane that meets or exceeds AAMA 712-14 requirements for mechanically attached flashing
- Excellent tear resistance
- Exceptional air and water holdout
- Easy to install in a variety of details
- Purposeful product printing — measurement indicators to assist with installation, and a QR code for quick access to product information
- Provides simple method for integrating self-adhered window flashing with the building wrap
- Part of the complete DuPont™ Tyvek® Weatherization System
- Backed by a 10-year Limited Warranty

### Ease of Installation

Tyvek® IntegrationWrap® was made in collaboration with window installation professionals to ensure the product is both effective and easy to install. The 9” width of the product makes it easy to incorporate into most window and door details.

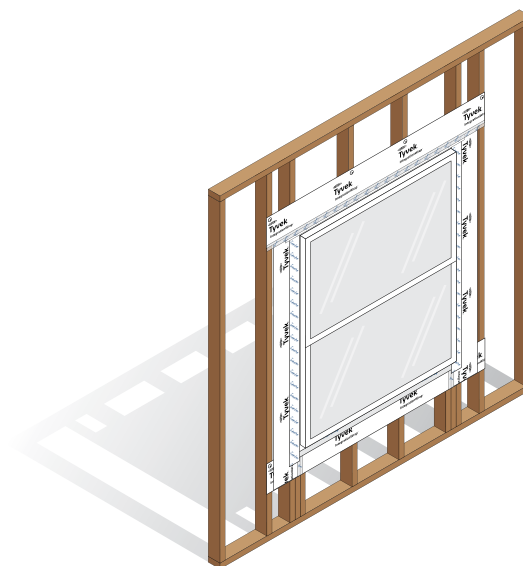

To provide additional ease of use in the field, a QR code is printed on the product for quick access to product information. Indicators are also printed every 6 inches to help with measuring and cutting. The product is pliable and light weight, making it a user friendly, practical flashing integration membrane.

See the [DuPont™ Tyvek® IntegrationWrap™ Installation Guidelines](#) on [building.dupont.com](http://building.dupont.com) for complete installation information.

### Available Sizes

Roll Width (in)	Roll Length (ft)	Roll coverage (ft²)
9	300	225

### Complete System

For maximum protection against air and water infiltration in homes and multi-family buildings, use Tyvek® IntegrationWrap™ combined with DuPont™ Tyvek® WRBs and DuPont Self-Adhered Flashing Products. Tyvek® WRBs include Tyvek® HomeWrap®, Tyvek® StuccoWrap®, Tyvek® DrainWrap™, Tyvek® CommercialWrap®, and Tyvek® CommercialWrap® D. DuPont Self-Adhered Flashing Products include DuPont™ FlexWrap™, DuPont™ FlexWrap™ EZ, DuPont™ StraightFlash™, DuPont™ VersaFlange™, and DuPont™ Flashing Tape. DuPont also offers installation accessories, including DuPont™ Tyvek® Tape, DuPont™ Tyvek® Wrap Caps, and Great Stuff Pro™ Polyurethane Foam Sealant.



## PROPERTIES

Tyvek® IntegrationWrap™ exhibits physical properties as shown in Table 1 when tested as represented. Review all instructions and (Material) Safety Data Sheet ((M)SDS) before use. Please contact your local DuPont Building Envelope Specialist before writing specifications around this product. Product properties are as follows:

**Table 1: Physical Properties of DuPont™ Tyvek® IntegrationWrap™**

Test Method	Property	Typical Value	Units
ASTM D1777	Thickness	7	mil
ASTM D882 ASTM D5034	Tensile Strength	60/67 95/126	MD/CD, lbf
ASTM D4533	Tear Resistance	22/37	MD/CD, lbf
ASTM F1306	Puncture Resistance	20	lbf
AATCC 127 (Dynamic Method) AATCC 127 (Static Method)	Material Water Resistance: Hydrostatic Head Pressure	> 500 PASS	cm water column 55 cm for 24 hours
ASTM E331	Assembly Water Resistance*	300 6.24	Pa psf
ASTM E96 Method A (Dry Cup) ASTM E96 Method B (Wet Cup)	Water Vapor Transmission	< 1	perms
TAPPI T-460 (Gurley Method)	Material Air Resistance	> 10,000	sec/100 cc
ASTM E1677	Assembly Air Leakage*	< 0.04	cfm/ft² (0.2 L/s • m²)
ASTM G154	Ultra-Violet Light (UV) Exposure Limit	120	Days
ASTM D1970	Low Temp. Flexibility	PASS	---
AAMA 712-14	Voluntary Specification for Mechanically Attached Flexible Flashing	PASS	---

\*Tyvek® IntegrationWrap™ tested in a wall assembly containing a window. In accordance with the [DuPont™ Tyvek® IntegrationWrap™ Installation Guidelines](#), DuPont Self-Adhered Flashing Products were used to flash window to Tyvek® IntegrationWrap™, with Tyvek® IntegrationWrap™ sealed to Tyvek® WRB on the wall using DuPont™ Tyvek® Tape.

## HANDLING AND ADDITIONAL INFORMATION

**WARNING: For Professional Use Only.** Read and follow the entire *Handling* section and the Safety Data Sheets (SDSs, formerly MSDSs or Material Safety Data Sheets) carefully before use. The information below is designed to protect the user and allow for safe use and handling of Tyvek® Brand products.

### Precautionary Statements

- DuPont™ Tyvek® IntegrationWrap™ should not be exposed to sunlight for more than 120 days.
- Tyvek® IntegrationWrap™ is slippery and should not be used in any application where it will be walked on.
- Tyvek® IntegrationWrap™ is combustible and should be protected from flames and other high heat sources. Tyvek® IntegrationWrap™ will melt at 320°F (160°C).
- Because of the critical technical design aspects of many of its applications, DuPont recommends that qualified designers or consultants design the wall system. Contact a local DuPont Building Envelope Specialist for more specific instructions.
- Follow all applicable federal, state, local and employer regulations.

### Storage and Disposal

Tyvek® IntegrationWrap™ should be stored in a clean, dry environment. Dispose of any residual product, coated debris, or solvent in accordance with applicable federal, state, and local government regulations.

### Warranty

Tyvek® IntegrationWrap™ is backed by a 10-year limited warranty. For more information, contact your local DuPont Building Envelope Specialist or see the [DuPont Building Envelope Solutions Products 10-Year Limited Warranty for Single-Family, Wood-Framed Multi-Family, and Light Commercial Buildings, For Projects Located in the United States Climate Zones 2B and 3B](#).

### Code Information

Tyvek® IntegrationWrap™ meets 2018 and 2021 International Residential Code (IRC) requirements for mechanically attached flashing, i.e. AAMA 712-14. Contact your DuPont Building Envelope Specialist or local authorities for state/provincial and local building code requirements and related acceptances.



**For more information visit us at  
[building.dupont.com](http://building.dupont.com)  
or call 1-833-338-7668**

**NOTICE:** No freedom from any patent owned by DuPont or others is to be inferred. Because use conditions and applicable laws may differ from one location to another and may change with time, Customer is responsible for determining whether products and the information in this document are appropriate for Customer's use and for ensuring that Customer's workplace and disposal practices are in compliance with applicable laws and other government enactments. The product shown in this literature may not be available for sale and/or available in all geographies where DuPont is represented. The claims made may not have been approved for use in all countries or regions. DuPont assumes no obligation or liability for the information in this document. References to "DuPont" or the "Company" mean the DuPont legal entity selling the products to Customer unless otherwise expressly noted. NO EXPRESS WARRANTIES ARE GIVEN EXCEPT FOR ANY APPLICABLE WRITTEN WARRANTIES SPECIFICALLY PROVIDED BY DUPONT. ALL IMPLIED WARRANTIES INCLUDING THOSE OF MERCHANTABILITY AND FITNESS FOR A PARTICULAR PURPOSE ARE EXPRESSLY EXCLUDED. The buyer assumes all risks as to the use of the material. Failure to strictly adhere to any recommended procedures shall release DuPont Specialty Products USA, LLC or its affiliates, of all liability with respect to the materials or the use thereof. The information herein is not intended for use by non-professional designers, applicators or other persons who do not purchase or utilize this product in the normal course of their business.